

PREMIUM LIST



**RED CANYONS KENNEL CLUB**

*Licensed by the American Kennel Club*

**FRIDAY, SEPTEMBER 8, 2023 AM SHOW 1**

**FRIDAY, SEPTEMBER 8, 2023 PM SHOW 2**

**SATURDAY, SEPTEMBER 9, 2023**

**SUNDAY, SEPTEMBER 10, 2023**

**AKC NATIONAL OWNER-HANDLED SERIES ALL 4 SHOWS**

**INDOORS, UNBENCHED • SHOW HOURS: 6:00 am to 7:00 pm**

**WASHINGTON COUNTY REGIONAL LEGACY PARK FAIRGROUNDS**

5500 West 700 South (Indoor Arena and Covered Arena)  
Hurricane, UT 84737

**ENTRIES CLOSE NOON WEDNESDAY, AUGUST 23, 2023 PDT**

**IMPORTANT NOTICE**

Mail Entries with Fees to Jack Bradshaw

320 Maple Avenue, Torrance, CA 90503

Make checks payable to Jack Bradshaw

FAX: (323) 727-2949 E-MAIL ENTRIES: www.jbradshaw.com

For entries made online there will be a service fee of \$4.00 per dog per show.

There will be a \$4.00 service fee if entries are cancelled for any reason per dog per show.

These service fees are non-refundable.

Include MasterCard, Visa or American Express number & expiration date

There will be a \$4.00 convenience fee charged per dog per show when using a credit card for payment of hand delivered or mailed in entries. Fax machines are available 24 hours a day.

Hand Deliveries - 320 Maple Avenue, Torrance, CA 90503

All entries with fees must be in the office of the Superintendent not later than

**NOON WEDNESDAY, AUGUST 23, 2023 PT**

After which time no entries may be accepted, cancelled, changed, substituted, corrected, completed, or signed and no entry fees refunded. Any change or cancellation must be made in writing and received prior to closing, except as provided for in Chapter 11, Section 6 of the American Kennel Club Dog Show Rules. Fax entries that are received incomplete or unable to read will not be accepted. The proof of transmission is not proof for verifying faxed entries. PLEASE DO NOT WAIT UNTIL THE CLOSE OF ENTRY DAY TO FAX OR E-MAIL YOUR ENTRIES. IF YOU FAX OR E-MAIL ON A CLOSE OF ENTRY DAY, PLEASE SUBMIT PRIOR TO 9:00 AM.

**ENTRY FEES**

First entry of a dog at this show* .....	\$32.00
Each additional class for the same dog .....	28.00
Puppy (6-9 or 9-12)* .....	28.00
Junior Showmanship .....	20.00
Junior Showmanship as an additional class.....	Free

\*(Entry fees include \$.50 AKC recording fee and \$3.00 AKC event services fee)

RAMP - At the discretion of the judge, the following breeds may be judged on a ramp through all levels of competition: Lagotto Romagnolo, Nova Scotia Duck Tolling Retriever, American Water Spaniel, Boykin Spaniels, English Springer Spaniel, Field Spaniel, Welsh Springer Spaniel, Grand Basset Griffon Vendeen, Whippet, German Pinscher, Standard Schnauzer, American Staffordshire Terrier, Irish Terrier, Soft Coated Wheaten Terrier, Staffordshire Bull Terrier, Finnish Spitz, Entlebucher Mountain Dog, Finnish Lapphund, Icelandic Sheepdog, Mudi, Norwegian Buhund, Polish Lowland Sheepdog, Spanish Water Dog, Norrbottenspet, Mudi.

The following breeds may be judged on the ground, table or ramp: Miniature Bull Terrier.

The following breeds must be judged on a ramp through all levels of conformation competition: Clumber Spaniel, Sussex Spaniel, Basset Hound, Cirneco dell'Etna, Kerry Blue Terrier, Bulldog, Chinese Shar-Pei, Chow Chow, Keeshond.

Junior showmanship judges should follow the above.

Ramps may be used in emergency situations to judge any breed. (In all but emergency situations, the exhibitor has no recourse. In an emergency situation, where use of a ramp is not indicated in the premium list, an exhibitor has the option of withdrawing their entry and receiving a refund.) 3/29/23

# RED CANYONS KENNEL CLUB

(Licensed by the American Kennel Club)

## FRIDAY, SEPTEMBER 8, 2023 AM SHOW 1

*Limit of 600 entries includes conformation, juniors, obedience. No limit on Rally*

## FRIDAY, SEPTEMBER 8, 2023 SECOND SHOW 2

*Limit of 600 entries includes conformation, juniors. No trials offered*

## SATURDAY, SEPTEMBER 9, 2023 *No Limit*

## SUNDAY, SEPTEMBER 10, 2023 *No Limit*

### AKC NATIONAL OWNER-HANDLED SERIES ALL 4 SHOWS

INDOORS, UNBENCHED • SHOW HOURS: 6:00 AM to 7:00 SECOND

### WASHINGTON COUNTY REGIONAL LEGACY PARK FAIRGROUNDS

5500 West 700 South INDOOR ARENA AND COVERED ARENA

Hurricane, UT 84737



### CERTIFICATION

Permission has been granted by the American Kennel Club for the holding of this event under American Kennel Club rules and regulations.

**Gina M. DiNardo, Executive Secretary**

### OFFICIAL PHOTOGRAPHER

Bettina Bienefeld [bestinshowphoto.com](http://bestinshowphoto.com)

Only the listed official photographer may take win pictures. A win picture is defined as consisting of a judge, dog and ribbons.

---

## ***Superintendents***

---

***Jack Bradshaw Dog Show Superintendents/Est. 1898***

***320 Maple Avenue, Torrance, CA 90503***

***Telephone: (323) 727-0136; FAX: (323) 727-2949; WEB: [www.jbradshaw.com](http://www.jbradshaw.com)***

***Marion Bradshaw / Barbara Bradshaw / Susan Bradshaw MacLyman***

***Julie Bradshaw Draper / John Bradshaw / Eloise O'Donnell / Keith MacLyman***

---

**One or more of the above superintendents will attend the show**

---

## A Message from Red Canyons Kennel Club

Hello everyone,

I am Dave Showalter, the President of RCKC. I have some exciting news for you. This year we have added a fourth show to our weekend for 2023. It has been our goal from the beginning of our journey to find a way to maximize our shows in a way to present our club as a special weekend for all the exhibitors, judges, and visitors who come to Southern Utah.

Beginning this year, we will take advantage of the AKC ruling that allows us to have four shows in three days by having both an AM and PM show on the first day. We hope that this adds to your showing experience while here in September. We will continue to have extra services provided to you while here. Our OFA testing services and microchipping, that we initiated last year, will again be available in 2023.

Due to a venue glitch caused by a change in management at Legacy Park, we will have a different logistical site setup FOR THIS YEAR ONLY.

All conformation rings will be inside of the Indoor Arena.

The Rally and Obedience trials will be in the outdoor covered arena. We will do our best to cool the covered arena if needed for this year. We will not be using the Harmony Building, FOR THIS YEAR ONLY. We will however, go back to a more spread-out format in 2024.

We will still have the same RV and Grooming reservations available this year. We have a limited number of both 50amp and 30amp spots, along with dry RV and day parking spots. Please remember that if you want either your RV or Grooming spots with other people, please make your reservations on our club website as a group. Please see the reservation page here in the Premium for further details.

Please reach out to me personally if I can either help you or direct you to the appropriate person for assistance.

My email is [entradadave@msn.com](mailto:entradadave@msn.com) and my phone number is 435-668-0969.

Thank you all for considering our shows and I look forward to seeing you in September.

### Saturday Sept 9 2023

Join us half hour after Best in Show for our annual 9/11 tribute with refreshments by the Raffle Table

We encourage people to join the celebration and wear Red White Blue Patriot colors on Saturday

**In the spirit of Good Sportsmanship,  
the Show Chairman will not handle dogs at these show.**

**OFFICERS**

President..... Dave Showalter  
Vice-President ..... Erica Muno  
Treasurer ..... Kristi Martin  
Recording Secretary..... Marlece Loper  
Corresponding Secretary ..... Pam Earl  
PO Box 1371, St George Utah 84771     [redcanyonskennelclub@gmail.com](mailto:redcanyonskennelclub@gmail.com)

**BOARD OF DIRECTORS**

Lorene Chidester, Karen Green, Rebecca White. Lori Holohan, Gail Workman

**SHOW COMMITTEE**

Dave Showalter ..... **Show Chairman**  
2022 W 1940 N St, St. George UT 84770 • (435) 668-0969 • [entradadave@msn.com](mailto:entradadave@msn.com)  
Marlece Loper..... **Assistant Show Chairperson**  
Gail Workman..... **Trial Chairman, Chief Trial Steward**  
If you are interested in stewarding for rally or obedience contact Gail at [otchcocker1@earthlink.net](mailto:otchcocker1@earthlink.net)  
Kathryn Martel..... **Chief Ring Steward**  
If you are interested in stewarding for RCKC contact Kathryn at [sunnystone@earthlink.net](mailto:sunnystone@earthlink.net)

**COMMITTEES**

Kristi Martin..... Catalogs  
Erica Muno..... Grooming  
Lori Holohan ..... RV Parking  
Karen Green & Penny Jensen ..... Hospitality  
Pam Earl ..... Raffle  
P Filomena Diaz Johnson ..... Trophies  
Dennis Maugherman ..... Grounds  
Gayle Eisenberg ..... Health Clinic  
Kathryn Martel ..... Chief Conformation Ring Steward  
Gail Workman..... Chief Trial Ring Steward

---

**RIBBONS**

The following ribbon prizes will be awarded:

First Prize - <b>Blue Ribbon</b>	Third Prize - <b>Yellow Ribbon</b>
Second Prize - <b>Red Ribbon</b>	Fourth Prize - <b>White Ribbon</b>
Winners - <b>Purple Ribbon</b>	
Reserve Winners - <b>Purple and White Ribbon</b>	
Best of Winners - <b>Blue and White Ribbon</b>	
Best of Breed and Best of Variety of Breed - <b>Purple and Gold Ribbon</b>	
Select – <b>Light Blue and White Ribbon</b>	
Best of Opposite Sex to Best of Breed or Variety of Breed - <b>Red and White Ribbon</b>	
Best in Show - <b>Red, White and Blue Rosette</b>	
Reserve Best In Show – <b>Red, Silver and Blue Rosette</b>	
Best Junior Handler– <b>Rose and Green Rosette</b>	
Reserve Best Junior Handler– <b>Rose and Gray Rosette</b>	
High In Trial – <b>Blue and Gold Rosette</b>	
Highest Combined Score in Obedience Trial – <b>Blue and Green Rosette</b>	
Highest Combined Score in Rally – <b>Blue and Green Rosette</b>	
Highest Triple Qualifying in Rally – <b>Blue and Red Rosette</b>	
Qualifying Score in Obedience and Rally – <b>Green Ribbon</b>	

And the following ribbon prizes for all non-regular classes:

First Prize - <b>Rose Ribbon</b>	Third Prize - <b>Light Green Ribbon</b>
Second Prize - <b>Brown Ribbon</b>	Fourth Prize - <b>Gray Ribbon</b>

**A rosette is offered for New Champions and New Titleholders.**

## CLASSIFICATION

This classification applies to each breed, whose name is listed. Any change in regular or non-regular classes appears under the individual breed heading.

### REGULAR CLASSES

Puppy Dogs 6 mos. and under 9 mos.	Puppy Bitches 6 mos. and under 9 mos.
Puppy Dogs 9 mos. and under 12 mos.	Puppy Bitches 9 mos. and under 12 mos.
12 mos. and under 18 mos. Dogs	12 mos. and under 18 mos. Bitches
Novice Dogs	Novice Bitches
Amateur Owner Handler Dogs	Amateur Owner Handler Bitches
Bred by Exhibitor Dogs	Bred by Exhibitor Bitches
American Bred Dogs	American Bred Bitches
Open Dogs	Open Bitches
Winners Dog	Winners Bitch

### NON-REGULAR CLASSES, INVOLVING SINGLE DOG ENTRIES

**Veteran (divided by sex)**- 7 years of age and older

#### BEST OF BREED (VARIETY) COMPETITION

**Best of Breed (Variety) Competition** - "The following categories of dogs may be entered and shown in Best of Breed competition. Dogs that are Champions of Record. Dogs which according to their owner's records have completed the requirements for a championship but whose championships are unconfirmed. The entry and showing of dogs whose championships are unconfirmed is limited to a period of 90 days from the date of the show where a dog completed the requirements for a championship according to the owner's records. If, at the end of the 90-day period, the championship of a dog has not been confirmed by the American Kennel Club, no further entries of the dog for Best of Breed competition are to be made until its championship has been confirmed by the AKC."

#### JUNIOR SHOWMANSHIP CLASSIFICATION

Novice Junior	Novice Intermediate	Novice Senior
Open Junior	Open Intermediate	Open Senior
		Master

**ALL-AMERICAN/MIXED BREEDS ARE ALLOWED IN THESE TRIALS**

#### OBEDIENCE CLASSIFICATION

Novice A	Open A	Utility A
Novice B	Open B	Utility B

#### OBEDIENCE CLASSIFICATION – OPTIONAL TITLING CLASSES

Beginner Novice A	Beginner Novice B	
Graduate Novice	Graduate Open	Versatility
Preferred Novice	Preferred Open	Preferred Utility

#### RALLY CLASSIFICATION

Novice A, Novice B, Intermediate, Advanced A, Advanced B,  
Excellent A, Excellent B, Master, Choice

*Dogs will be judged in descending height order – include your jump height*

## **JUDGES**

<b>Mrs. Judith A. Brown</b>	71711 Hill Top Ln, Kingwood, TX 77339
<b>Mrs. Terry B. Carter</b>	183033 153 Street West, Foothills AB CANADA T1S 0YB
<b>Ms. Gina Grissom</b>	9209 Priscilla St, Downey, CA 90242
<b>Miss Bonnie Lee</b>	7809 Sand Harbor Court, Las Vegas, NV 89128
<b>Ms. Kimberly Anne Meredith</b>	5315 Averill Dr, Grants Pass, OR 97526
<b>Ms. Nikki Riggsbee</b>	3412 Blowing Oak St, Valrico, FL 33596
<b>Mrs. Patricia V. Trotter</b>	P.O. Box 222036, Carmel, CA 93922
<b>Mr. John P. Wade</b>	299 Steptoe Lane, Washoe Valley, NV 89704

\*Judge was Provisional/Permit status for the assignment on the date the panel was approved by AKC.

## FRIDAY # 1

### BEST in SHOW

Mrs. Terry B. Carter

### SPORTING BREEDS

Ms. Kimberly Anne Meredith

Barbets .....	Ms. Meredith
Bracchi Italiani .....	Ms. Meredith
Brittanys .....	Ms. Meredith
Lagotto Romagnolos .....	Ms. Meredith
Nederlandse Kooikerhondjes .....	Ms. Meredith
Pointer .....	Ms. Meredith
Pointers (German Shorthaired) .....	Ms. Meredith
Pointers (German Wirehaired) .....	Ms. Meredith
Retrievers (Chesapeake Bay) .....	Ms. Meredith
Retrievers (Curly-Coated) .....	Ms. Meredith
Retrievers (Flat-Coated) .....	Ms. Meredith
Retrievers (Golden) .....	Ms. Meredith
Retrievers (Labrador) .....	Ms. Meredith
Open, Black; Chocolate; Yellow. Same division of classes in bitches.	
Retrievers (NS Duck Tolling) .....	Ms. Meredith
Setters (English) .....	Ms. Meredith
Setters (Gordon) .....	Ms. Meredith
Setters (Irish) .....	Ms. Meredith
Setters (Irish, Red and White) .....	Ms. Meredith
Spaniels (American Water) .....	Ms. Meredith
Spaniels (Boykin) .....	Ms. Meredith
Spaniels (Clumber) .....	Ms. Meredith
Spaniels (Cocker) Black .....	Ms. Meredith
Spaniels (Cocker) Ascob .....	Ms. Meredith
Spaniels (Cocker) Parti Color .....	Ms. Meredith
Spaniels (English Cocker) .....	Ms. Meredith
Spaniels (English Springer) .....	Ms. Meredith
Spaniels (Field) .....	Ms. Meredith
Spaniels (Irish Water) .....	Ms. Meredith
Spaniels (Sussex) .....	Ms. Meredith
Spaniels (Welsh Springer) .....	Ms. Meredith
Spinoni Italiani .....	Ms. Meredith
Vizslas .....	Ms. Meredith
Weimaraners .....	Ms. Meredith
Wirehaired Pointing Griffons .....	Ms. Meredith
Wirehaired Vizslas .....	Ms. Meredith

### HOUD BREEDS

Ms. Kimberly Anne Meredith

Afghan Hounds .....	Mrs. Trotter
American English Coonhounds .....	Mrs. Trotter
American Foxhounds .....	Mrs. Trotter
Azawakh .....	Mrs. Trotter
Basenjis .....	Mrs. Trotter
Basset Hounds .....	Mrs. Trotter
Beagles (Thirteen Inch) .....	Mrs. Trotter
Beagles (Fifteen Inch) .....	Mrs. Trotter
Black and Tan Coonhounds .....	Mrs. Trotter
Bloodhounds .....	Mrs. Trotter
Bluetick Coonhounds .....	Mrs. Trotter
Borzoi .....	Mrs. Trotter
Cirnechi dell Etna .....	Mrs. Trotter
Dachshunds (Longhaired) .....	Mrs. Trotter
Open, Miniature 11 lbs. and under at 12 mos. of age and older; Standard. Same division of classes in bitches.	
Dachshunds (Smooth) .....	Mrs. Trotter
Open, Miniature 11 lbs. and under at 12 mos. of age and older; Standard. Same division of classes in bitches.	
Dachshunds (Wirehaired) .....	Mrs. Trotter
Open, Miniature 11 lbs. and under at 12 mos. of age and older; Standard. Same division of classes in bitches.	
Foxhounds (English) .....	Mrs. Trotter
Grand Basset Griffon Vendeens .....	Mrs. Trotter
Greyhounds .....	Mrs. Trotter
Harriers .....	Mrs. Trotter
Ibizan Hounds .....	Mrs. Trotter
Irish Wolfhounds .....	Mrs. Trotter
Norwegian Elkhounds .....	Mrs. Trotter
Otterhounds .....	Mrs. Trotter
Petits Bassets Griffons Vendeens .....	Mrs. Trotter

Pharaoh Hounds .....	Mrs. Trotter
Plott Hounds .....	Mrs. Trotter
Portuguese Podengo Pequenos .....	Mrs. Trotter
Redbone Coonhound .....	Mrs. Trotter
Rhodesian Ridgebacks .....	Mrs. Trotter
Salukis .....	Mrs. Trotter
Scottish Deerhounds .....	Mrs. Trotter
Sloughi .....	Mrs. Trotter
Treeing Walker Coonhounds .....	Mrs. Trotter
Whippets .....	Mrs. Trotter

### WORKING BREEDS

Mr. John P. Wade

Akitas .....	Mrs. Brown
Alaskan Malamutes .....	Mrs. Brown
Anatolian Shepherds .....	Mrs. Brown
Bernese Mountain Dogs .....	Mrs. Brown
Black Russian Terriers .....	Mrs. Brown
Boerboel .....	Mrs. Brown
Boxers .....	Mrs. Brown
Open, Brindle; Fawn. Same division of classes in bitches.	
Bullmastiffs .....	Mrs. Brown
Open, Brindle; Any Other Allowed Color. Same division of classes in bitches.	
Cane Corso .....	Mrs. Brown
Chinook .....	Mrs. Brown
Doberman Pinschers .....	Mrs. Brown
Open, Black; Any Other Allowed Color. Same division of classes in bitches.	
Dogos Argentino .....	Mrs. Brown
Dogue De Bordeaux .....	Mrs. Brown
German Pinschers .....	Mrs. Brown
Giant Schnauzers .....	Mrs. Brown
Great Danes .....	Mrs. Brown
Open, Black; Blue; Brindle; Fawn; Harlequin; Mantle; Merle. Same division of classes in bitches.	
Great Pyrenees .....	Mrs. Brown
Greater Swiss Mountain Dogs .....	Mrs. Brown
Komondorok .....	Mrs. Brown
Kuvaszok .....	Mrs. Brown
Leonberger .....	Mrs. Brown
Mastiffs .....	Mrs. Brown
Neapolitan Mastiffs .....	Mrs. Brown
Newfoundlands .....	Mrs. Brown
Portuguese Water Dogs .....	Mrs. Brown
Rottweilers .....	Mrs. Brown
S T. Bernards .....	Mrs. Brown
Samoyeds .....	Mrs. Brown
Siberian Huskies .....	Mrs. Brown
Standard Schnauzers .....	Mrs. Brown
Tibetan Mastiffs .....	Mrs. Brown

### TERRIER BREEDS

Mr. John P. Wade

Airedale Terriers .....	Mrs. Carter
American Hairless Terriers .....	Mrs. Carter
American Staffordshire Terriers .....	Mrs. Carter
Australian Terriers .....	Mrs. Carter
Bedlington Terriers .....	Mrs. Carter
Border Terriers .....	Mrs. Carter
Bull Terriers (Colored) .....	Mrs. Carter
Bull Terriers (White) .....	Mrs. Carter
Cairn Terriers .....	Mrs. Carter
Cesky Terriers .....	Mrs. Carter
Dandie Dinmont Terriers .....	Mrs. Carter
Fox Terriers (Smooth) .....	Mrs. Carter
Fox Terriers (Wire) .....	Mrs. Carter
Glen of Imaal Terriers .....	Mrs. Carter
Irish Terriers .....	Mrs. Carter
Kerry Blue Terriers .....	Mrs. Carter
Lakeland Terriers .....	Mrs. Carter
Manchester Terriers (Standard) .....	Mrs. Carter
Miniature Bull Terriers .....	Mrs. Carter
Miniature Schnauzers .....	Mrs. Carter
Norfolk Terriers .....	Mrs. Carter
Norwich Terriers .....	Mrs. Carter
Parson Russell Terriers .....	Mrs. Carter
Rat Terriers .....	Mrs. Carter
Russell Terriers .....	Mrs. Carter
Scottish Terriers .....	Mrs. Carter



## FRIDAY # 1

Sealyham Terriers.....	Mrs. Carter
Skye Terriers.....	Mrs. Carter
Soft Coated Wheaten Terriers .....	Mrs. Carter
Staffordshire Bull Terriers .....	Mrs. Carter
Welsh Terriers.....	Mrs. Carter
West Highland White Terriers .....	Mrs. Carter

## TOY BREEDS

Ms. Nikki Riggsbee

Affenpinschers.....	Ms. Riggsbee
Biewer Terrier.....	Ms. Riggsbee
Brussels Griffons.....	Ms. Riggsbee
Cavalier King Charles Spaniels.....	Ms. Riggsbee
Open, Black & Tan; Blenheim; Ruby; Tri-Color. Same division of classes in bitches.	
Chihuahuas (Long Coat).....	Ms. Riggsbee
Chihuahuas (Smooth Coat).....	Ms. Riggsbee
Chinese Crested.....	Ms. Riggsbee
Open, Hairless; Powderpuff. Same division of classes in bitches.	
English Toy Spaniel (Blenheim & Prince Charles).....	Ms. Riggsbee
English Toy Spaniel (King Charles & Ruby).....	Ms. Riggsbee
Havanese.....	Ms. Riggsbee
Italian Greyhounds.....	Ms. Riggsbee
Japanese Chin.....	Ms. Riggsbee
Maltese.....	Ms. Riggsbee
Manchester Terriers (Toy).....	Ms. Riggsbee
Miniature Pinschers.....	Ms. Riggsbee
Papillons.....	Ms. Riggsbee
Pekingese.....	Ms. Riggsbee
Pomeranian.....	Ms. Riggsbee
Open, Red, Orange, Cream and Sable; Black, Brown and Blue; Any Other Allowed Color. Same division of classes in bitches.	
Poodle (Toy).....	Ms. Riggsbee
Pugs.....	Ms. Riggsbee
Open, Black; Fawn. Same division of classes in bitches.	
Russian Toy.....	Ms. Riggsbee
Shih Tzu.....	Ms. Riggsbee
Silky Terriers.....	Ms. Riggsbee
Toy Fox Terriers.....	Ms. Riggsbee
Yorkshire Terriers.....	Ms. Riggsbee

## NON-SPORTING BREEDS

Mr. John P. Wade

American Eskimos.....	Mr. Wade
Bichons Frises.....	Mr. Wade
Boston Terriers.....	Mr. Wade
Open, under 15 lbs.; 15 lbs and over Same division of classes in bitches.	
Bulldogs.....	Mr. Wade
Chinese Shar-Pei.....	Mr. Wade
Chow Chows.....	Mr. Wade
Open, Black; Red; Any Other Allowed Color. Same division of classes in bitches.	
Coton de Tulear.....	Mr. Wade
Dalmatians.....	Mr. Wade
Open, Black Spotted; Liver-Spotted. Same divi- sion of classes in bitches.	
Finnish Spitz.....	Mr. Wade
French Bulldogs.....	Mr. Wade
Keeshonden.....	Mr. Wade
Lhasa Apsos.....	Mr. Wade
Lowchen.....	Mr. Wade
Norwegian Lundehunds.....	Mr. Wade
Poodles (Miniature).....	Mr. Wade
Poodles (Standard).....	Mr. Wade
Schipperkes.....	Mr. Wade
Shiba-Inu.....	Mr. Wade
Tibetan Spaniels.....	Mr. Wade
Tibetan Terriers.....	Mr. Wade
Xoloitzcuintli.....	Mr. Wade

## HERDING BREEDS

Mrs. Patricia V. Trotter

Australian Cattle Dogs.....	Mrs. Carter
-----------------------------	-------------

Australian Shepherds.....	Mrs. Carter
Open, Black; Blue Merle; Red Merle; Red. Same division of classes in bitches.	
Bearded Collies.....	Mrs. Carter
Beauceron.....	Mrs. Carter
Belgian Laekenois.....	Mrs. Carter
Belgian Malinois.....	Mrs. Carter
Belgian Sheepdogs.....	Mrs. Carter
Belgian Tervuren.....	Mrs. Carter
Bergamasco Sheepdogs.....	Mrs. Carter
Berger Picard.....	Mrs. Carter
Border Collies.....	Mrs. Carter
Bouvier Des Flandres.....	Mrs. Carter
Briards.....	Mrs. Carter
Canaan Dog.....	Mrs. Carter
Cardigan Welsh Corgis.....	Mrs. Carter
Collies (Rough).....	Mrs. Carter
Open, Blue; Sable & White; TriColor; White Same division of classes in bitches.	
Collies (Smooth).....	Mrs. Carter
Entlebucher Mountain Dogs.....	Mrs. Carter
Finnish Lapphund.....	Mrs. Carter
German Shepherd Dogs.....	Mrs. Carter
Icelandic Sheepdogs.....	Mrs. Carter
Miniature American Shepherd.....	Mrs. Carter
Open, Black; Blue Merle; Red Merle; Red. Same division of classes in bitches.	
Mudi.....	Mrs. Carter
Norwegian Buhunds.....	Mrs. Carter
Old English Sheepdogs.....	Mrs. Carter
Pembroke Welsh Corgis.....	Mrs. Carter
Polish Lowland Sheepdogs.....	Mrs. Carter
Pulik.....	Mrs. Carter
Pumik.....	Mrs. Carter
Pyrenean Shepherds.....	Mrs. Carter
Shetland Sheepdogs.....	Mrs. Carter
Open, Sable and White; Any Other Allowed Color. Same division of classes in bitches.	
Spanish Water Dog.....	Mrs. Carter
Swedish Vallhunds.....	Mrs. Carter

## MISCELLANEOUS CLASS

Ms. Nikki Riggsbee

There will be a puppy, bred by and open class for dogs and bitches in each breed: Danish-Swedish Farmdog, Dutch Shepherd, Japan Akitainu, Kai Ken, Lancashire Heeler, Norrbottenspets, Peruvian Inca Orchid, Basset Fauve de Bretagne, Portuguese Podengo, Russian Tsvetanaya Bolonka, Small Munsterlander, Teddy Roosevelt Terrier.

## JUNIOR SHOWMANSHIP COMPETITION

Mrs. Judith A. Brown

## OBEDIENCE

Beginner Novice A.....	Miss Lee
Beginner Novice B.....	Miss Lee
Graduate Novice.....	Miss Lee
Graduate Open.....	Miss Lee
Novice Class A.....	Miss Lee
Novice Class B.....	Miss Lee
Open Class A.....	Miss Lee
Open Class B.....	Miss Lee
Preferred Novice.....	Miss Lee
Preferred Open.....	Miss Lee
Preferred Utility.....	Miss Lee
Utility Class A.....	Miss Lee
Utility Class B.....	Miss Lee
Versatility Class.....	Miss Lee
Rally Novice A.....	Ms. Grissom
Rally Novice B.....	Ms. Grissom
Rally Intermediate.....	Ms. Grissom
Rally Advanced A.....	Ms. Grissom
Rally Advanced B.....	Ms. Grissom
Rally Excellent A.....	Ms. Grissom
Rally Excellent B.....	Ms. Grissom
Rally Master.....	Ms. Grissom
Rally Choice.....	Ms. Grissom

## FRIDAY # 2

### BEST in SHOW

Ms. Nikki Riggsbee

### SPORTING BREEDS

Mrs. Patricia V. Trotter

Barbets .....	Mrs. Carter
Bracchi Italiani .....	Mrs. Carter
Brittanys .....	Mrs. Carter
Lagotto Romagnolos .....	Mrs. Carter
Nederlandse Kooikerhondjes .....	Mrs. Carter
Pointer .....	Mrs. Carter
Pointers (German Shorthaired) .....	Mrs. Carter
Pointers (German Wirehaired) .....	Mrs. Carter
Retrievers (Chesapeake Bay) .....	Mrs. Carter
Retrievers (Curly-Coated) .....	Mrs. Carter
Retrievers (Flat-Coated) .....	Mrs. Carter
Retrievers (Golden) .....	Mrs. Carter
Retrievers (Labrador) .....	Mrs. Carter
Open, Black; Chocolate; Yellow. Same division of classes in bitches.	
Retrievers (NS Duck Tolling) .....	Mrs. Carter
Setters (English) .....	Mrs. Carter
Setters (Gordon) .....	Mrs. Carter
Setters (Irish) .....	Mrs. Carter
Setters (Irish, Red and White) .....	Mrs. Carter
Spaniels (American Water) .....	Mrs. Carter
Spaniels (Boykin) .....	Mrs. Carter
Spaniels (Clumber) .....	Mrs. Carter
Spaniels (Cocker) Black .....	Mrs. Carter
Spaniels (Cocker) Ascob .....	Mrs. Carter
Spaniels (Cocker) Parti Color .....	Mrs. Carter
Spaniels (English Cocker) .....	Mrs. Carter
Spaniels (English Springer) .....	Mrs. Carter
Spaniels (Field) .....	Mrs. Carter
Spaniels (Irish Water) .....	Mrs. Carter
Spaniels (Sussex) .....	Mrs. Carter
Spaniels (Welsh Springer) .....	Mrs. Carter
Spinoni Italiani .....	Mrs. Carter
Vizslas .....	Mrs. Carter
Weimaraners .....	Mrs. Carter
Wirehaired Pointing Griffons .....	Mrs. Carter
Wirehaired Vizslas .....	Mrs. Carter

### HOUND BREEDS

Mrs. Patricia V. Trotter

Afghan Hounds .....	Mrs. Brown
American English Coonhounds .....	Mrs. Brown
American Foxhounds .....	Mrs. Brown
Azawakh .....	Mrs. Brown
Basenjis .....	Mrs. Brown
Basset Hounds .....	Mrs. Brown
Beagles (Thirteen Inch) .....	Mrs. Brown
Beagles (Fifteen Inch) .....	Mrs. Brown
Black and Tan Coonhounds .....	Mrs. Brown
Bloodhounds .....	Mrs. Brown
Bluetick Coonhounds .....	Mrs. Brown
Borzoi .....	Mrs. Brown
Cirnechi dell Etna .....	Mrs. Brown
Dachshunds (Longhaired) .....	Mrs. Brown
Open, Miniature 11 lbs. and under at 12 mos. of age and older; Standard. Same division of classes in bitches.	
Dachshunds (Smooth) .....	Mrs. Brown
Open, Miniature 11 lbs. and under at 12 mos. of age and older; Standard. Same division of classes in bitches.	
Dachshunds (Wirehaired) .....	Mrs. Brown
Open, Miniature 11 lbs. and under at 12 mos. of age and older; Standard. Same division of classes in bitches.	
Foxhounds (English) .....	Mrs. Brown
Grand Basset Griffon Vendeens .....	Mrs. Brown

Greyhounds .....	Mrs. Brown
Harriers .....	Mrs. Brown
Ibizan Hounds .....	Mrs. Brown
Irish Wolfhounds .....	Mrs. Brown
Norwegian Elkhounds .....	Mrs. Brown
Otterhounds .....	Mrs. Brown
Petits Bassets Griffons Vendeens .....	Mrs. Brown
Pharaoh Hounds .....	Mrs. Brown
Plott Hounds .....	Mrs. Brown
Portuguese Podengo Pequenos .....	Mrs. Brown
Redbone Coonhound .....	Mrs. Brown
Rhodesian Ridgebacks .....	Mrs. Brown
Salukis .....	Mrs. Brown
Scottish Deerhounds .....	Mrs. Brown
Sloughi .....	Mrs. Brown
Treeing Walker Coonhounds .....	Mrs. Brown
Whippets .....	Mrs. Brown

### WORKING BREEDS

Ms. Kimberly Anne Meredith

Akitas .....	Mr. Wade
Alaskan Malamutes .....	Mr. Wade
Anatolian Shepherds .....	Mr. Wade
Bernese Mountain Dogs .....	Mr. Wade
Black Russian Terriers .....	Mr. Wade
Boerboel .....	Mr. Wade
Boxers .....	Mr. Wade
Open, Brindle; Fawn. Same division of classes in bitches.	
Bullmastiffs .....	Mr. Wade
Open, Brindle; Any Other Allowed Color. Same division of classes in bitches.	
Cane Corso .....	Mr. Wade
Chinook .....	Mr. Wade
Doberman Pinschers .....	Mr. Wade
Open, Black; Any Other Allowed Color. Same division of classes in bitches.	
Dogos Argentino .....	Mr. Wade
Dogue De Bordeaux .....	Mr. Wade
German Pinschers .....	Mr. Wade
Giant Schnauzers .....	Mr. Wade
Great Danes .....	Mr. Wade
Open, Black; Blue; Brindle; Fawn; Harlequin; Mantle; Merle. Same division of classes in bitches.	
Great Pyrenees .....	Mr. Wade
Greater Swiss Mountain Dogs .....	Mr. Wade
Komondorok .....	Mr. Wade
Kuvaszok .....	Mr. Wade
Leonberger .....	Mr. Wade
Mastiffs .....	Mr. Wade
Neapolitan Mastiffs .....	Mr. Wade
Newfoundlands .....	Mr. Wade
Portuguese Water Dogs .....	Mr. Wade
Rottweilers .....	Mr. Wade
S T. Bernards .....	Mr. Wade
Samoyeds .....	Mr. Wade
Siberian Huskies .....	Mr. Wade
Standard Schnauzers .....	Mr. Wade
Tibetan Mastiffs .....	Mr. Wade

### TERRIER BREEDS

Mrs. Terry B. Carter

Airedale Terriers .....	Mrs. Trotter
American Hairless Terriers .....	Mrs. Trotter
American Staffordshire Terriers .....	Mrs. Trotter
Australian Terriers .....	Mrs. Trotter
Bedlington Terriers .....	Mrs. Trotter
Border Terriers .....	Mrs. Trotter
Bull Terriers (Colored) .....	Mrs. Trotter
Bull Terriers (White) .....	Mrs. Trotter
Cairn Terriers .....	Mrs. Trotter
Cesky Terriers .....	Mrs. Trotter
Dandie Dinmont Terriers .....	Mrs. Trotter
Fox Terriers (Smooth) .....	Mrs. Trotter

## FRIDAY # 2

Fox Terriers (Wire).....	Mrs. Trotter
Glen of Imaal Terriers .....	Mrs. Trotter
Irish Terriers.....	Mrs. Trotter
Kerry Blue Terriers.....	Mrs. Trotter
Lakeland Terriers.....	Mrs. Trotter
Manchester Terriers (Standard).....	Mrs. Trotter
Miniature Bull Terriers.....	Mrs. Trotter
Miniature Schnauzers.....	Mrs. Trotter
Norfolk Terriers.....	Mrs. Trotter
Norwich Terriers.....	Mrs. Trotter
Parson Russell Terriers .....	Mrs. Trotter
Rat Terriers.....	Mrs. Trotter
Russell Terriers.....	Mrs. Trotter
Scottish Terriers.....	Mrs. Trotter
Sealyham Terriers.....	Mrs. Trotter
Skye Terriers.....	Mrs. Trotter
Soft Coated Wheaten Terriers .....	Mrs. Trotter
Staffordshire Bull Terriers .....	Mrs. Trotter
Welsh Terriers.....	Mrs. Trotter
West Highland White Terriers .....	Mrs. Trotter

## TOY BREEDS

Ms. Kimberly Anne Meredith

Affenpinschers.....	Ms. Meredith
Biewer Terrier .....	Ms. Meredith
Brussels Griffons .....	Ms. Meredith
Cavalier King Charles Spaniels .....	Ms. Meredith
Open, Black & Tan; Blenheim; Ruby; Tri-Color.	
Same division of classes in bitches.	
Chihuahuas (Long Coat).....	Ms. Meredith
Chihuahuas (Smooth Coat).....	Ms. Meredith
Chinese Crested.....	Ms. Meredith
Open, Hairless; Powderpuff. Same division of	
classes in bitches.	
English Toy Spaniel	
(Blenheim & Prince Charles).....	Ms. Meredith
English Toy Spaniel	
(King Charles & Ruby).....	Ms. Meredith
Havanese .....	Ms. Meredith
Italian Greyhounds .....	Ms. Meredith
Japanese Chin.....	Ms. Meredith
Maltese .....	Ms. Meredith
Manchester Terriers (Toy).....	Ms. Meredith
Miniature Pinschers .....	Ms. Meredith
Papillons.....	Ms. Meredith
Pekingese.....	Ms. Meredith
Pomeranian .....	Ms. Meredith
Open, Red, Orange, Cream and Sable; Black,	
Brown and Blue; Any Other Allowed Color.	
Same division of classes in bitches.	
Poodle (Toy).....	Ms. Meredith
Pugs .....	Ms. Meredith
Open, Black; Fawn. Same division of classes in	
bitches.	
Russian Toy.....	Ms. Meredith
Shih Tzu .....	Ms. Meredith
Silky Terriers.....	Ms. Meredith
Toy Fox Terriers.....	Ms. Meredith
Yorkshire Terriers.....	Ms. Meredith

## NON-SPORTING BREEDS

Ms. Kimberly Anne Meredith

American Eskimos.....	Ms. Riggsbee
Bichons Frises.....	Ms. Riggsbee
Boston Terriers .....	Ms. Riggsbee
Open, under 15 lbs.; 15 lbs and over Same	
division of classes in bitches.	
Bulldogs.....	Ms. Riggsbee
Chinese Shar-Pei .....	Ms. Riggsbee
Chow Chows .....	Ms. Riggsbee
Open, Black; Red; Any Other Allowed Color.	
Same division of classes in bitches.	
Coton de Tulear.....	Ms. Riggsbee
Dalmatians.....	Ms. Riggsbee

Open, Black Spotted; Liver-Spotted. Same divi-  
sion of classes in bitches.

Finnish Spitz .....	Ms. Riggsbee
French Bulldogs.....	Ms. Riggsbee
Keeshonden.....	Ms. Riggsbee
Lhasa Apsos .....	Ms. Riggsbee
Lowchen .....	Ms. Riggsbee
Norwegian Lundehunds.....	Ms. Riggsbee
Poodles (Miniature).....	Ms. Riggsbee
Poodles (Standard).....	Ms. Riggsbee
Schipperkes .....	Ms. Riggsbee
Shiba-Inu .....	Ms. Riggsbee
Tibetan Spaniels .....	Ms. Riggsbee
Tibetan Terriers .....	Ms. Riggsbee
Xoloitzcuintli.....	Ms. Riggsbee

## HERDING BREEDS

Mrs. Judith A. Brown

Australian Cattle Dogs.....	Mrs. Trotter
Australian Shepherds .....	Mrs. Trotter
Open, Black; Blue Merle; Red Merle; Red.	
Same division of classes in bitches.	
Bearded Collies .....	Mrs. Trotter
Beauceron .....	Mrs. Trotter
Belgian Laekenois .....	Mrs. Trotter
Belgian Malinois.....	Mrs. Trotter
Belgian Sheepdogs.....	Mrs. Trotter
Belgian Tervuren.....	Mrs. Trotter
Bergamasco Sheepdogs .....	Mrs. Trotter
Berger Picard.....	Mrs. Trotter
Border Collies .....	Mrs. Trotter
Bouvier Des Flandres .....	Mrs. Trotter
Briards .....	Mrs. Trotter
Canaan Dog.....	Mrs. Trotter
Cardigan Welsh Corgis.....	Mrs. Trotter
Collies (Rough).....	Mrs. Trotter
Open, Blue; Sable & White; TriColor; White	
Same division of classes in bitches.	
Collies (Smooth).....	Mrs. Trotter
Entlebucher Mountain Dogs .....	Mrs. Trotter
Finnish Lapphund .....	Mrs. Trotter
German Shepherd Dogs.....	Mrs. Trotter
Icelandic Sheepdogs .....	Mrs. Trotter
Miniature American Shepherd .....	Mrs. Trotter
Open, Black; Blue Merle; Red Merle; Red.	
Same division of classes in bitches.	
Mudi.....	Mrs. Trotter
Norwegian Buhunds .....	Mrs. Trotter
Old English Sheepdogs .....	Mrs. Trotter
Pembroke Welsh Corgis .....	Mrs. Trotter
Polish Lowland Sheepdogs .....	Mrs. Trotter
Pulik.....	Mrs. Trotter
Pumik.....	Mrs. Trotter
Pyrenean Shepherds.....	Mrs. Trotter
Shetland Sheepdogs .....	Mrs. Trotter
Open, Sable and White; Any Other Allowed	
Color. Same division of classes in bitches.	
Spanish Water Dog.....	Mrs. Trotter
Swedish Vallhunds.....	Mrs. Trotter

## MISCELLANEOUS CLASS

Mrs. Terry B. Carter

There will be a puppy, bred by and open class for dogs  
and bitches in each breed: Danish-Swedish Farmdog,  
Dutch Shepherd, Japan Akitainu, Kai Ken, Lancashire  
Heeler, Norrbottenspets, Peruvian Inca Orchid, Basset  
Fauve de Bretagne, Portuguese Podengo, Russian  
Tsvetanaya Bolonka, Small Munsterlander, Teddy  
Roosevelt Terrier.

## JUNIOR SHOWMANSHIP COMPETITION

Mrs. Patricia V. Trotter

## SATURDAY

### BEST in SHOW

Mrs. Patricia V. Trotter

### SPORTING BREEDS

Mrs. Judith A. Brown

Barbets	Ms. Riggsbee
Bracchi Italiani	Ms. Riggsbee
Brittany	Ms. Riggsbee
Lagotto Romagnolos	Ms. Riggsbee
Nederlandse Kooikerhondjes	Ms. Riggsbee
Pointer	Ms. Riggsbee
Pointers (German Shorthaired)	Ms. Riggsbee
Pointers (German Wirehaired)	Ms. Riggsbee
Retrievers (Chesapeake Bay)	Ms. Riggsbee
Retrievers (Curly-Coated)	Ms. Riggsbee
Retrievers (Flat-Coated)	Ms. Riggsbee
Retrievers (Golden)	Ms. Riggsbee
Retrievers (Labrador)	Ms. Riggsbee
Open, Black; Chocolate; Yellow. Same division of classes in bitches.	
Retrievers (NS Duck Tolling)	Ms. Riggsbee
Setters (English)	Ms. Riggsbee
Setters (Gordon)	Ms. Riggsbee
Setters (Irish)	Ms. Riggsbee
Setters (Irish, Red and White)	Ms. Riggsbee
Spaniels (American Water)	Ms. Riggsbee
Spaniels (Boykin)	Ms. Riggsbee
Spaniels (Clumber)	Ms. Riggsbee
Spaniels (Cocker) Black	Ms. Riggsbee
Spaniels (Cocker) Ascob	Ms. Riggsbee
Spaniels (Cocker) Parti Color	Ms. Riggsbee
Spaniels (English Cocker)	Ms. Riggsbee
Spaniels (English Springer)	Ms. Riggsbee
Spaniels (Field)	Ms. Riggsbee
Spaniels (Irish Water)	Ms. Riggsbee
Spaniels (Sussex)	Ms. Riggsbee
Spaniels (Welsh Springer)	Ms. Riggsbee
Spinoni Italiani	Ms. Riggsbee
Vizslas	Ms. Riggsbee
Weimaraners	Ms. Riggsbee
Wirehaired Pointing Griffons	Ms. Riggsbee
Wirehaired Vizslas	Ms. Riggsbee

### HOUND BREEDS

Ms. Nikki Riggsbee

Afghan Hounds	Mr. Wade
American English Coonhounds	Mr. Wade
American Foxhounds	Mr. Wade
Azawakh	Mr. Wade
Basenjis	Mr. Wade
Basset Hounds	Mr. Wade
Beagles (Thirteen Inch)	Mr. Wade
Beagles (Fifteen Inch)	Mr. Wade
Black and Tan Coonhounds	Mr. Wade
Bloodhounds	Mr. Wade
Bluetick Coonhounds	Mr. Wade
Borzoi	Mr. Wade
Cirnechi dell Etna	Mr. Wade
Dachshunds (Longhaired)	Mr. Wade
Open, Miniature 11 lbs. and under at 12 mos. of age and older; Standard. Same division of classes in bitches.	
Dachshunds (Smooth)	Mr. Wade
Open, Miniature 11 lbs. and under at 12 mos. of age and older; Standard. Same division of classes in bitches.	
Dachshunds (Wirehaired)	Mr. Wade
Open, Miniature 11 lbs. and under at 12 mos. of age and older; Standard. Same division of classes in bitches.	
Foxhounds (English)	Mr. Wade
Grand Basset Griffon Vendeens	Mr. Wade
Greyhounds	Mr. Wade
Harriers	Mr. Wade
Ibizan Hounds	Mr. Wade
Irish Wolfhounds	Mr. Wade
Norwegian Elkhounds	Mr. Wade
Otterhounds	Mr. Wade
Petits Bassets Griffons Vendeens	Mr. Wade

Pharaoh Hounds	Mr. Wade
Plott Hounds	Mr. Wade
Portuguese Podengo Pequenos	Mr. Wade
Redbone Coonhound	Mr. Wade
Rhodesian Ridgebacks	Mr. Wade
Salukis	Mr. Wade
Scottish Deerhounds	Mr. Wade
Sloughi	Mr. Wade
Treeing Walker Coonhounds	Mr. Wade
Whippets	Mr. Wade

### WORKING BREEDS

Mrs. Terry B. Carter

Akitas	Mrs. Trotter
Alaskan Malamutes	Mrs. Trotter
Anatolian Shepherds	Mrs. Trotter
Bernese Mountain Dogs	Mrs. Trotter
Black Russian Terriers	Mrs. Trotter
Boerboel	Mrs. Trotter
Boxers	Mrs. Trotter
Open, Brindle; Fawn. Same division of classes in bitches.	
Bullmastiffs	Mrs. Trotter
Open, Brindle; Any Other Allowed Color. Same division of classes in bitches.	
Cane Corso	Mrs. Trotter
Chinook	Mrs. Trotter
Doberman Pinschers	Mrs. Trotter
Open, Black; Any Other Allowed Color. Same division of classes in bitches.	
Dogos Argentino	Mrs. Trotter
Dogue De Bordeaux	Mrs. Trotter
German Pinschers	Mrs. Trotter
Giant Schnauzers	Mrs. Trotter
Great Danes	Mrs. Trotter
Open, Black; Blue; Brindle; Fawn; Harlequin; Mantle; Merle. Same division of classes in bitches.	
Great Pyrenees	Mrs. Trotter
Greater Swiss Mountain Dogs	Mrs. Trotter
Komondorok	Mrs. Trotter
Kuvaszok	Mrs. Trotter
Leonberger	Mrs. Trotter
Mastiffs	Mrs. Trotter
Neapolitan Mastiffs	Mrs. Trotter
Newfoundlands	Mrs. Trotter
Portuguese Water Dogs	Mrs. Trotter
Rottweilers	Mrs. Trotter
S T. Bernards	Mrs. Trotter
Samoyeds	Mrs. Trotter
Siberian Huskies	Mrs. Trotter
Standard Schnauzers	Mrs. Trotter
Tibetan Mastiffs	Mrs. Trotter

### TERRIER BREEDS

Ms. Nikki Riggsbee

Airedale Terriers	Ms. Riggsbee
American Hairless Terriers	Ms. Riggsbee
American Staffordshire Terriers	Ms. Riggsbee
Australian Terriers	Ms. Riggsbee
Bedlington Terriers	Ms. Riggsbee
Border Terriers	Ms. Riggsbee
Bull Terriers (Colored)	Ms. Riggsbee
Bull Terriers (White)	Ms. Riggsbee
Cairn Terriers	Ms. Riggsbee
Cesky Terriers	Ms. Riggsbee
Dandie Dinmont Terriers	Ms. Riggsbee
Fox Terriers (Smooth)	Ms. Riggsbee
Fox Terriers (Wire)	Ms. Riggsbee
Glen of Imaal Terriers	Ms. Riggsbee
Irish Terriers	Ms. Riggsbee
Kerry Blue Terriers	Ms. Riggsbee
Lakeland Terriers	Ms. Riggsbee
Manchester Terriers (Standard)	Ms. Riggsbee
Miniature Bull Terriers	Ms. Riggsbee
Miniature Schnauzers	Ms. Riggsbee
Norfolk Terriers	Ms. Riggsbee
Norwich Terriers	Ms. Riggsbee
Parson Russell Terriers	Ms. Riggsbee
Rat Terriers	Ms. Riggsbee
Russell Terriers	Ms. Riggsbee
Scottish Terriers	Ms. Riggsbee

## SATURDAY

Sealyham Terriers.....	Ms. Riggsbee
Skye Terriers.....	Ms. Riggsbee
Soft Coated Wheaten Terriers .....	Ms. Riggsbee
Staffordshire Bull Terriers .....	Ms. Riggsbee
Welsh Terriers.....	Ms. Riggsbee
West Highland White Terriers .....	Ms. Riggsbee

## TOY BREEDS

Mrs. Terry B. Carter

Affenpinschers.....	Mrs. Carter
Biewer Terrier .....	Mr. Wade
Brussels Griffons .....	Mrs. Carter
Cavalier King Charles Spaniels .....	Mrs. Carter
Open, Black & Tan; Blenheim; Ruby; Tri-Color. Same division of classes in bitches.	
Chihuahuas (Long Coat) .....	Mrs. Carter
Chihuahuas (Smooth Coat) .....	Mrs. Carter
Chinese Crested .....	Mrs. Carter
Open, Hairless; Powderpuff. Same division of classes in bitches.	
English Toy Spaniel (Blenheim & Prince Charles) .....	Mrs. Carter
English Toy Spaniel (King Charles & Ruby).....	Mrs. Carter
Havanese .....	Mrs. Carter
Italian Greyhounds .....	Mrs. Carter
Japanese Chin.....	Mrs. Carter
Maltese .....	Mrs. Carter
Manchester Terriers (Toy).....	Mrs. Carter
Miniature Pinschers .....	Mrs. Carter
Papillons.....	Mrs. Carter
Pekingese.....	Mrs. Carter
Pomeranian .....	Mrs. Carter
Open, Red, Orange, Cream and Sable; Black, Brown and Blue; Any Other Allowed Color. Same division of classes in bitches.	
Poodle (Toy) .....	Mrs. Carter
Pugs .....	Mrs. Carter
Open, Black; Fawn. Same division of classes in bitches.	
Russian Toy .....	Mrs. Carter
Shih Tzu .....	Mrs. Carter
Silky Terriers.....	Mrs. Carter
Toy Fox Terriers.....	Mrs. Carter
Yorkshire Terriers.....	Mrs. Carter

## NON-SPORTING BREEDS

Mrs. Judith A. Brown

American Eskimos.....	Mrs. Brown
Bichons Frises.....	Mrs. Brown
Boston Terriers .....	Mrs. Brown
Open, under 15 lbs.; 15 lbs and over Same division of classes in bitches.	
Bulldogs.....	Mrs. Brown
Chinese Shar-Pei .....	Mrs. Brown
Chow Chows .....	Mrs. Brown
Open, Black; Red; Any Other Allowed Color. Same division of classes in bitches.	
Coton de Tulear .....	Mrs. Brown
Dalmatians.....	Mrs. Brown
Open, Black Spotted; Liver-Spotted. Same divi- sion of classes in bitches.	
Finnish Spitz .....	Mrs. Brown
French Bulldogs.....	Mrs. Brown
Keeshonden .....	Mrs. Brown
Lhasa Apsos .....	Mrs. Brown
Lowchen .....	Mrs. Brown
Norwegian Lundehunds.....	Mrs. Brown
Poodles (Miniature) .....	Mrs. Brown
Poodles (Standard).....	Mrs. Brown
Schipperkes .....	Mrs. Brown
Shiba-Inu .....	Mrs. Brown
Tibetan Spaniels .....	Mrs. Brown
Tibetan Terriers.....	Mrs. Brown
Xoloitzcuintli.....	Mrs. Brown

## HERDING BREEDS

Mrs. Terry B. Carter

Australian Cattle Dogs.....	Ms. Meredith
-----------------------------	--------------

Australian Shepherds .....	Ms. Meredith
Open, Black; Blue Merle; Red Merle; Red. Same division of classes in bitches.	
Bearded Collies .....	Ms. Meredith
Beauceron .....	Ms. Meredith
Belgian Laekenois .....	Ms. Meredith
Belgian Malinois.....	Ms. Meredith
Belgian Sheepdogs.....	Ms. Meredith
Belgian Tervuren .....	Ms. Meredith
Bergamasco Sheepdogs .....	Ms. Meredith
Berger Picard.....	Ms. Meredith
Border Collies .....	Ms. Meredith
Bouvier Des Flandres .....	Ms. Meredith
Briards .....	Ms. Meredith
Canaan Dog.....	Ms. Meredith
Cardigan Welsh Corgis.....	Ms. Meredith
Collies (Rough).....	Ms. Meredith
Open, Blue; Sable & White; TriColor; White Same division of classes in bitches.	
Collies (Smooth) .....	Ms. Meredith
Entlebucher Mountain Dogs .....	Ms. Meredith
Finnish Lapphund .....	Ms. Meredith
German Shepherd Dogs.....	Ms. Meredith
Icelandic Sheepdogs .....	Ms. Meredith
Miniature American Shepherd .....	Ms. Meredith
Open, Black; Blue Merle; Red Merle; Red. Same division of classes in bitches.	
Mudi.....	Ms. Meredith
Norwegian Buhunds .....	Ms. Meredith
Old English Sheepdogs .....	Ms. Meredith
Pembroke Welsh Corgis .....	Ms. Meredith
Polish Lowland Sheepdogs .....	Ms. Meredith
Pulik.....	Ms. Meredith
Pumik.....	Ms. Meredith
Pyrenean Shepherds .....	Ms. Meredith
Shetland Sheepdogs .....	Ms. Meredith
Open, Sable and White; Any Other Allowed Color. Same division of classes in bitches.	
Spanish Water Dog .....	Ms. Meredith
Swedish Vallhunds.....	Ms. Meredith

## MISCELLANEOUS CLASS

Ms. Kimberly Anne Meredith

There will be a puppy, bred by and open class for dogs and bitches in each breed: Danish-Swedish Farmdog, Dutch Shepherd, Japan Akitainu, Kai Ken, Lancashire Heeler, Norrbottenspets, Peruvian Inca Orchid, Basset Fauve de Bretagne, Portuguese Podengo, Russian Tsvetanaya Bolonka, Small Munsterlander, Teddy Roosevelt Terrier.

## JUNIOR SHOWMANSHIP COMPETITION

Ms. Kimberly Anne Meredith

## OBEDIENCE

Beginner Novice A .....	Ms. Grissom
Beginner Novice B .....	Ms. Grissom
Graduate Novice .....	Ms. Grissom
Graduate Open .....	Ms. Grissom
Novice Class A .....	Ms. Grissom
Novice Class B .....	Ms. Grissom
Open Class A.....	Ms. Grissom
Open Class B.....	Ms. Grissom
Preferred Novice .....	Ms. Grissom
Preferred Open .....	Ms. Grissom
Preferred Utility .....	Ms. Grissom
Utility Class A.....	Ms. Grissom
Utility Class B.....	Ms. Grissom
Versatility Class .....	Ms. Grissom
Rally Novice A .....	Miss Lee
Rally Novice B .....	Miss Lee
Rally Intermediate.....	Miss Lee
Rally Advanced A .....	Miss Lee
Rally Advanced B .....	Miss Lee
Rally Excellent A.....	Miss Lee
Rally Excellent B.....	Miss Lee
Rally Master.....	Miss Lee
Rally Choice.....	Miss Lee

## SUNDAY

### BEST in SHOW

Mrs. Judith A. Brown

### SPORTING BREEDS

Ms. Nikki Riggsbee

Barbets .....	Mrs. Trotter
Bracchi Italiani .....	Mrs. Trotter
Brittany's .....	Mrs. Trotter
Lagotto Romagnolos .....	Mrs. Trotter
Nederlandse Kooikerhondjes .....	Mrs. Trotter
Pointer .....	Mrs. Trotter
Pointers (German Shorthaired) .....	Mrs. Trotter
Pointers (German Wirehaired) .....	Mrs. Trotter
Retrievers (Chesapeake Bay) .....	Mrs. Trotter
Retrievers (Curly-Coated) .....	Mrs. Trotter
Retrievers (Flat-Coated) .....	Mrs. Trotter
Retrievers (Golden) .....	Mrs. Trotter
Retrievers (Labrador) .....	Mrs. Trotter
Open, Black; Chocolate; Yellow. Same division of classes in bitches.	
Retrievers (NS Duck Tolling) .....	Mrs. Trotter
Setters (English) .....	Mrs. Trotter
Setters (Gordon) .....	Mrs. Trotter
Setters (Irish) .....	Mrs. Trotter
Setters (Irish, Red and White) .....	Mrs. Trotter
Spaniels (American Water) .....	Mrs. Trotter
Spaniels (Boykin) .....	Mrs. Trotter
Spaniels (Clumber) .....	Mrs. Trotter
Spaniels (Cocker) Black .....	Mrs. Trotter
Spaniels (Cocker) Ascob .....	Mrs. Trotter
Spaniels (Cocker) Parti Color .....	Mrs. Trotter
Spaniels (English Cocker) .....	Mrs. Trotter
Spaniels (English Springer) .....	Mrs. Trotter
Spaniels (Field) .....	Mrs. Trotter
Spaniels (Irish Water) .....	Mrs. Trotter
Spaniels (Sussex) .....	Mrs. Trotter
Spaniels (Welsh Springer) .....	Mrs. Trotter
Spinoni Italiani .....	Mrs. Trotter
Vizslas .....	Mrs. Trotter
Weimaraners .....	Mrs. Trotter
Wirehaired Pointing Griffons .....	Mrs. Trotter
Wirehaired Vizslas .....	Mrs. Trotter

### HOUD BREEDS

Mr. John P. Wade

Afghan Hounds .....	Ms. Meredith
American English Coonhounds .....	Ms. Meredith
American Foxhounds .....	Ms. Meredith
Azawakh .....	Ms. Meredith
Basenjis .....	Ms. Meredith
Basset Hounds .....	Ms. Meredith
Beagles (Thirteen Inch) .....	Ms. Meredith
Beagles (Fifteen Inch) .....	Ms. Meredith
Black and Tan Coonhounds .....	Ms. Meredith
Bloodhounds .....	Ms. Meredith
Bluetick Coonhounds .....	Ms. Meredith
Borzoi .....	Ms. Meredith
Cirnechi dell Etna .....	Ms. Meredith
Dachshunds (Longhaired) .....	Ms. Meredith
Open, Miniature 11 lbs. and under at 12 mos. of age and older; Standard. Same division of classes in bitches.	
Dachshunds (Smooth) .....	Ms. Meredith
Open, Miniature 11 lbs. and under at 12 mos. of age and older; Standard. Same division of classes in bitches.	
Dachshunds (Wirehaired) .....	Ms. Meredith
Open, Miniature 11 lbs. and under at 12 mos. of age and older; Standard. Same division of classes in bitches.	
Foxhounds (English) .....	Ms. Meredith
Grand Basset Griffon Vendeens .....	Ms. Meredith
Greyhounds .....	Ms. Meredith
Harriers .....	Ms. Meredith
Ibizan Hounds .....	Ms. Meredith
Irish Wolfhounds .....	Ms. Meredith
Norwegian Elkhounds .....	Ms. Meredith
Otterhounds .....	Ms. Meredith
Petits Bassets Griffons Vendeens .....	Ms. Meredith

Pharaoh Hounds .....	Ms. Meredith
Plott Hounds .....	Ms. Meredith
Portuguese Podengo Pequenos .....	Ms. Meredith
Redbone Coonhound .....	Ms. Meredith
Rhodesian Ridgebacks .....	Ms. Meredith
Salukis .....	Ms. Meredith
Scottish Deerhounds .....	Ms. Meredith
Sloughi .....	Ms. Meredith
Treeing Walker Coonhounds .....	Ms. Meredith
Whippets .....	Ms. Meredith

### WORKING BREEDS

Ms. Nikki Riggsbee

Akitas .....	Ms. Riggsbee
Alaskan Malamutes .....	Ms. Riggsbee
Anatolian Shepherds .....	Ms. Riggsbee
Bernese Mountain Dogs .....	Ms. Riggsbee
Black Russian Terriers .....	Ms. Riggsbee
Boerboel .....	Ms. Riggsbee
Boxers .....	Ms. Riggsbee
Open, Brindle; Fawn. Same division of classes in bitches.	
Bullmastiffs .....	Ms. Riggsbee
Open, Brindle; Any Other Allowed Color. Same division of classes in bitches.	
Cane Corso .....	Ms. Riggsbee
Chinook .....	Ms. Riggsbee
Doberman Pinschers .....	Ms. Riggsbee
Open, Black; Any Other Allowed Color. Same division of classes in bitches.	
Dogos Argentino .....	Ms. Riggsbee
Dogue De Bordeaux .....	Ms. Riggsbee
German Pinschers .....	Ms. Riggsbee
Giant Schnauzers .....	Ms. Riggsbee
Great Danes .....	Ms. Riggsbee
Open, Black; Blue; Brindle; Fawn; Harlequin; Mantle; Merle. Same division of classes in bitches.	
Great Pyrenees .....	Ms. Riggsbee
Greater Swiss Mountain Dogs .....	Ms. Riggsbee
Komondorok .....	Ms. Riggsbee
Kuvaszok .....	Ms. Riggsbee
Leonberger .....	Ms. Riggsbee
Mastiffs .....	Ms. Riggsbee
Neapolitan Mastiffs .....	Ms. Riggsbee
Newfoundlands .....	Ms. Riggsbee
Portuguese Water Dogs .....	Ms. Riggsbee
Rottweilers .....	Ms. Riggsbee
S T. Bernards .....	Ms. Riggsbee
Samoyeds .....	Ms. Riggsbee
Siberian Huskies .....	Ms. Riggsbee
Standard Schnauzers .....	Ms. Riggsbee
Tibetan Mastiffs .....	Ms. Riggsbee

### TERRIER BREEDS

Mrs. Patricia V. Trotter

Airedale Terriers .....	Mr. Wade
American Hairless Terriers .....	Mr. Wade
Australian Staffordshire Terriers .....	Mr. Wade
Australian Terriers .....	Mr. Wade
Bedlington Terriers .....	Mr. Wade
Border Terriers .....	Mr. Wade
Bull Terriers (Colored) .....	Mr. Wade
Bull Terriers (White) .....	Mr. Wade
Cairn Terriers .....	Mr. Wade
Cesky Terriers .....	Mr. Wade
Dandie Dinmont Terriers .....	Mr. Wade
Fox Terriers (Smooth) .....	Mr. Wade
Fox Terriers (Wire) .....	Mr. Wade
Glen of Imaal Terriers .....	Mr. Wade
Irish Terriers .....	Mr. Wade
Kerry Blue Terriers .....	Mr. Wade
Lakeland Terriers .....	Mr. Wade
Manchester Terriers (Standard) .....	Mr. Wade
Miniature Bull Terriers .....	Mr. Wade
Miniature Schnauzers .....	Mr. Wade
Norfolk Terriers .....	Mr. Wade
Norwich Terriers .....	Mr. Wade
Parson Russell Terriers .....	Mr. Wade
Rat Terriers .....	Mr. Wade
Russell Terriers .....	Mr. Wade
Scottish Terriers .....	Mr. Wade

## SUNDAY

Sealyham Terriers.....	Mr. Wade
Skye Terriers.....	Mr. Wade
Soft Coated Wheaten Terriers .....	Mr. Wade
Staffordshire Bull Terriers .....	Mr. Wade
Welsh Terriers.....	Mr. Wade
West Highland White Terriers .....	Mr. Wade

## TOY BREEDS

Mrs. Patricia V. Trotter

Affenpinschers .....	Mrs. Brown
Biewer Terrier .....	Mrs. Trotter
Brussels Griffons .....	Mrs. Brown
Cavalier King Charles Spaniels .....	Mrs. Brown
Open, Black & Tan; Blenheim; Ruby; Tri-Color. Same division of classes in bitches.	
Chihuahuas (Long Coat) .....	Mrs. Brown
Chihuahuas (Smooth Coat) .....	Mrs. Brown
Chinese Crested .....	Mrs. Brown
Open, Hairless; Powderpuff. Same division of classes in bitches.	
English Toy Spaniel (Blenheim & Prince Charles) .....	Mrs. Brown
English Toy Spaniel (King Charles & Ruby).....	Mrs. Brown
Havanese .....	Mrs. Trotter
Italian Greyhounds .....	Mrs. Brown
Japanese Chin.....	Mrs. Trotter
Maltese .....	Mrs. Trotter
Manchester Terriers (Toy).....	Mrs. Brown
Miniature Pinschers .....	Mrs. Trotter
Papillons .....	Mrs. Brown
Pekingese .....	Mrs. Brown
Pomeranian .....	Mrs. Brown
Open, Red, Orange, Cream and Sable; Black, Brown and Blue; Any Other Allowed Color. Same division of classes in bitches.	
Poodle (Toy) .....	Mrs. Brown
Pugs .....	Mrs. Trotter
Open, Black; Fawn. Same division of classes in bitches.	
Russian Toy .....	Mrs. Trotter
Shih Tzu .....	Mrs. Brown
Silky Terriers .....	Mrs. Trotter
Toy Fox Terriers .....	Mrs. Trotter
Yorkshire Terriers.....	Mrs. Trotter

## NON-SPORTING BREEDS

Mrs. Patricia V. Trotter

American Eskimos .....	Mrs. Carter
Bichons Frises .....	Mrs. Carter
Boston Terriers .....	Mrs. Carter
Open, under 15 lbs.; 15 lbs and over Same division of classes in bitches.	
Bulldogs.....	Mrs. Carter
Chinese Shar-Pei .....	Mrs. Carter
Chow Chows .....	Mrs. Carter
Open, Black; Red; Any Other Allowed Color. Same division of classes in bitches.	
Coton de Tulear .....	Mrs. Carter
Dalmatians.....	Mrs. Carter
Open, Black Spotted; Liver-Spotted. Same divi- sion of classes in bitches.	
Finnish Spitz .....	Mrs. Carter
French Bulldogs .....	Mrs. Carter
Keeshonden .....	Mrs. Carter
Lhasa Apsos .....	Mrs. Carter
Lowchen .....	Mrs. Carter
Norwegian Lundehunds.....	Mrs. Carter
Poodles (Miniature) .....	Mrs. Carter
Poodles (Standard).....	Mrs. Carter
Schipperkes .....	Mrs. Carter
Shiba-Inu .....	Mrs. Carter
Tibetan Spaniels .....	Mrs. Carter
Tibetan Terriers.....	Mrs. Carter
Xoloitzcuintli.....	Mrs. Carter

## HERDING BREEDS

Ms. Kimberly Anne Meredith

Australian Cattle Dogs.....	Mr. Wade
-----------------------------	----------

Australian Shepherds .....	Mr. Wade
Open, Black; Blue Merle; Red Merle; Red. Same division of classes in bitches.	
Bearded Collies .....	Mr. Wade
Beauceron .....	Mr. Wade
Belgian Laekenois .....	Mr. Wade
Belgian Malinois.....	Mr. Wade
Belgian Sheepdogs.....	Mr. Wade
Belgian Tervuren .....	Mr. Wade
Bergamasco Sheepdogs .....	Mr. Wade
Berger Picard .....	Mr. Wade
Border Collies .....	Mr. Wade
Bouvier Des Flandres .....	Mr. Wade
Briards .....	Mr. Wade
Canaan Dog.....	Mr. Wade
Cardigan Welsh Corgis.....	Mr. Wade
Collies (Rough).....	Mr. Wade
Open, Blue; Sable & White; TriColor; White Same division of classes in bitches.	
Collies (Smooth) .....	Mr. Wade
Entlebucher Mountain Dogs .....	Mr. Wade
Finnish Lapphund .....	Mr. Wade
German Shepherd Dogs.....	Mr. Wade
Icelandic Sheepdogs .....	Mr. Wade
Miniature American Shepherd .....	Mr. Wade
Open, Black; Blue Merle; Red Merle; Red. Same division of classes in bitches.	
Mudi .....	Mr. Wade
Norwegian Buhunds .....	Mr. Wade
Old English Sheepdogs .....	Mr. Wade
Pembroke Welsh Corgis .....	Mr. Wade
Polish Lowland Sheepdogs .....	Mr. Wade
Pulik .....	Mr. Wade
Pumik .....	Mr. Wade
Pyrenean Shepherds .....	Mr. Wade
Shetland Sheepdogs .....	Mr. Wade
Open, Sable and White; Any Other Allowed Color. Same division of classes in bitches.	
Spanish Water Dog .....	Mr. Wade
Swedish Vallhunds.....	Mr. Wade

## MISCELLANEOUS CLASS

Mr. John P. Wade

There will be a puppy, bred by and open class for dogs and bitches in each breed: Danish-Swedish Farmdog, Dutch Shepherd, Japan Akitainu, Kai Ken, Lancashire Heeler, Norrbottenspets, Peruvian Inca Orchid, Basset Fauve de Bretagne, Portuguese Podengo, Russian Tsvetanaya Bolonka, Small Munsterlander, Teddy Roosevelt Terrier.

## JUNIOR SHOWMANSHIP COMPETITION

Mr. John P. Wade

## OBEDIENCE

Beginner Novice A .....	Miss Lee
Beginner Novice B .....	Miss Lee
Graduate Novice .....	Miss Lee
Graduate Open .....	Miss Lee
Novice Class A .....	Miss Lee
Novice Class B .....	Miss Lee
Open Class A.....	Miss Lee
Open Class B.....	Miss Lee
Preferred Novice .....	Miss Lee
Preferred Open .....	Miss Lee
Preferred Utility .....	Miss Lee
Utility Class A.....	Miss Lee
Utility Class B.....	Miss Lee
Versatility Class .....	Miss Lee
Rally Novice A .....	Ms. Grissom
Rally Novice B .....	Ms. Grissom
Rally Intermediate .....	Ms. Grissom
Rally Advanced A .....	Ms. Grissom
Rally Advanced B .....	Ms. Grissom
Rally Excellent A .....	Ms. Grissom
Rally Excellent B .....	Ms. Grissom
Rally Master.....	Ms. Grissom
Rally Choice.....	Ms. Grissom

## AKC National Owner-Handled Series

The AKC National Owner-Handled Series is a non-titling competition for dogs that are exhibited by their owners that are not professional handlers.

Exhibitors must declare their dog is Owner-Handled eligible at the time of entry on the entry form. Dogs entered in the Amateur-Owner-Handler class will automatically be marked as eligible to compete in the NOHS. Eligible dogs will be identified by an asterisk in the judge's book, steward's book & the catalog. **Dogs must be handled throughout the breed level competition for the regular show by an eligible owner. Professional handlers\*, household members and current assistants\*\* to professional handlers may not exhibit the dog in any NOHS competition during the entire show.**

Owner-Handled Best of Breed will be selected from the dogs that are eligible to compete in the Best of Breed competition including Winners Dog, Winners Bitch and winners of the non-regular classes.

- If the Best of Breed/Variety winner is Owner-Handled competition eligible, it will automatically be Owner-Handled Best of Breed/Variety and be eligible to compete in both the regular as well as the Owner-Handled group.
- If the Best of Breed/Variety winner is not eligible for Owner-Handled competition and the Best of Opposite Sex to Best of Breed/Variety is eligible, the Best of Opposite Sex to Best of Breed/Variety will compete against the eligible exhibits of the other sex to determine Owner-Handled Best of Breed/Variety.
- If neither the Best of Breed nor the Best of Opposite Sex to Best of Breed/Variety are Owner-Handled competition eligible and Select Dog & Select Bitch are both eligible, the judge is to choose Best Owner-Handled exhibit from the Selects and eligible Winners Dog or Winners Bitch.
- If one of the Selects is eligible, excuse all Champions and non-regular class winners of the same sex and then choose Best Owner-Handled exhibit from the remaining dogs of the opposite sex including the eligible Winners.
- If Best of Breed, Best of Opposite Sex to Best of Breed, Select Dog & Select Bitch are not eligible, the judge may choose any eligible dog remaining in the ring including Winners Dog or Winners Bitch as Owner-Handled Best of Breed/Variety.
- If the Best of Winners is eligible, the other Winner is ineligible since it was defeated.
- No class dogs other than the Winners Dog & Winners Bitch are eligible to return to the ring.

The breed will not be represented in the Owner-Handled Group if there is no eligible dog competing in the Best of Breed or in Best of Winners competition.

*\*Professional handlers are defined as any person who belongs or has belonged to a professional handlers' organization, distributed rate cards, or otherwise advertised or represented themselves as handling dogs for pay within the last five years*

*\*\*A current assistant is defined as anyone employed by a professional handler on a full-time basis or assisting a professional handler at the show or any time during the cluster/weekend. Current assistants that are eligible to compete in Junior Showmanship (meet age & amateur status requirements) may participate in NOHS. AKC Revised 5/11/18*

	Friday # 1	Friday # 2	Saturday	Sunday
Sporting	Mrs. Trotter	Ms. Riggsbee	Ms. Meredith	Mrs. Carter
Hounds	Mrs. Trotter	Mr. Wade	Ms. Meredith	Mrs. Brown
Working	Mrs. Brown	Mrs. Carter	Ms. Riggsbee	Mr. Wade
Terriers	Mrs. Carter	Ms. Riggsbee	Mrs. Trotter	Mr. Wade
Toys	Mrs. Brown	Ms. Riggsbee	Mr. Wade	Mrs. Carter
NonSporting	Ms. Riggsbee	Mrs. Brown	Mr. Wade	Ms. Meredith
Herding	Mrs. Carter	Mr. Wade	Mrs. Trotter	Mrs. Brown
BISOH	Mr. Wade	Ms. Meredith	Mrs. Carter	Mrs. Trotter



## ROUTES TO THE SHOW

### FROM 1-15: EXIT 16 Hurricane SR 9 head South

Travel 2.5 miles southeast on State Route 9.

Then turn right at 5300 West. This is the second signal light. (if you turn left you will end up at Quail Creek Reservoir).

Then go about .4 mile

Follow 5300W pass the DMV.

Keep going as it merges onto 5500W.

Then to Washington County Legacy Park and Fairgrounds.

Parking lot will be on your left side Go past the buildings

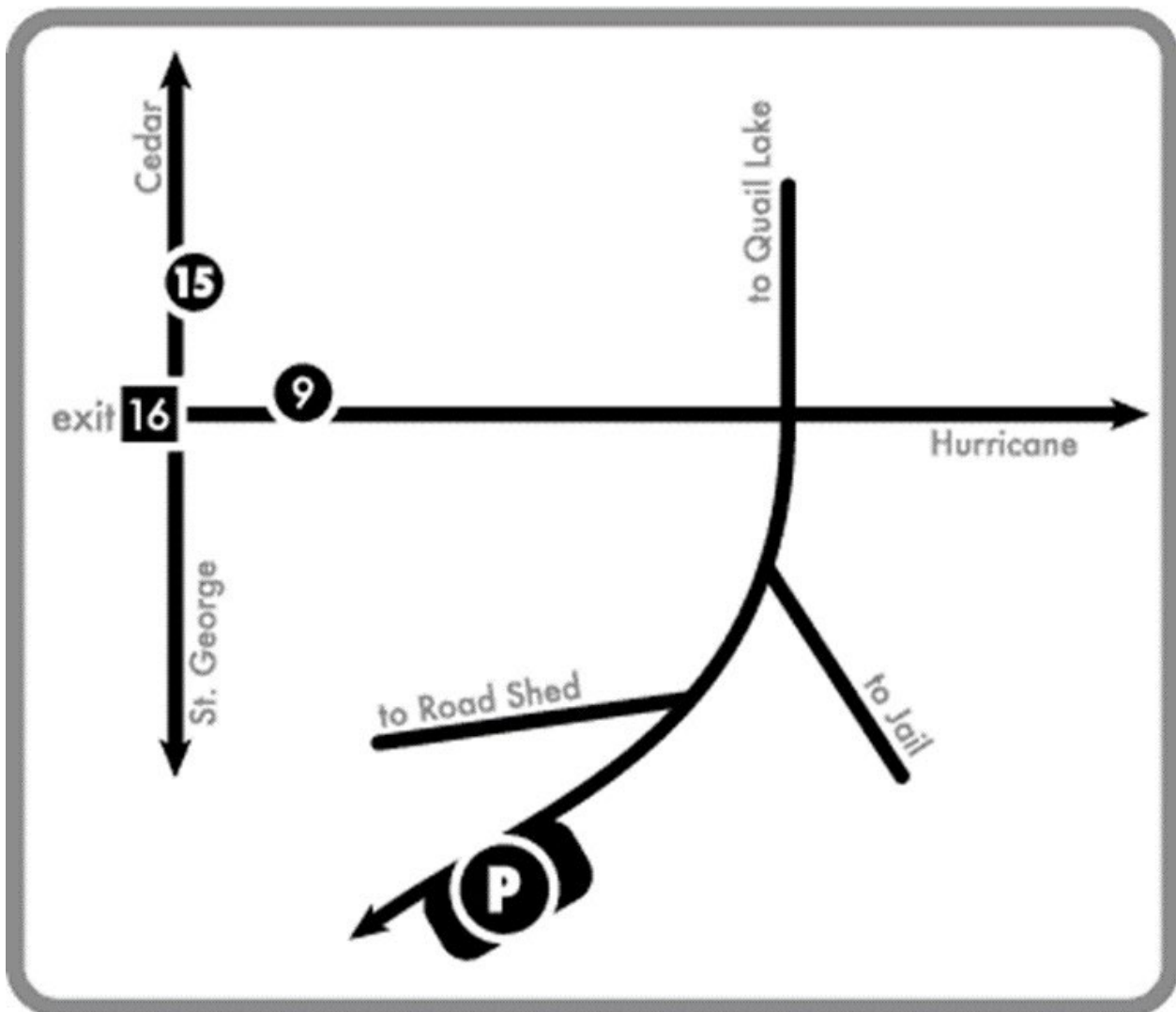

## SHOW VETERINARIAN

Southwest Animal Emergency Services (ON CALL) 1067 E Tabernacle, St George UT 84770 • (435) 673-3191

**DIRECTIONS TO SOUTHWEST ANIMAL EMERGENCY SERVICES:** Go back to I-15, head south toward St George. Follow I-15 S to Exit 8 to St George Blvd. Turn right on St George Blvd & then left on 1000 East. Take the next left at Tabernacle & go about a block.

**Lava Rock Veterinary Hospital Pet's Urgent Care** Hours Tuesday – Friday 10am-10pm  
Saturday 10am-6pm Closed Sunday & Monday  
Limited Holiday Hours Walk-Ins Only Friday and Saturday 200N 1000E St. George, UT, 84770  
For emergencies or scheduling call us at 435-288-0288  
For general questions you can text us at 435-359-4494

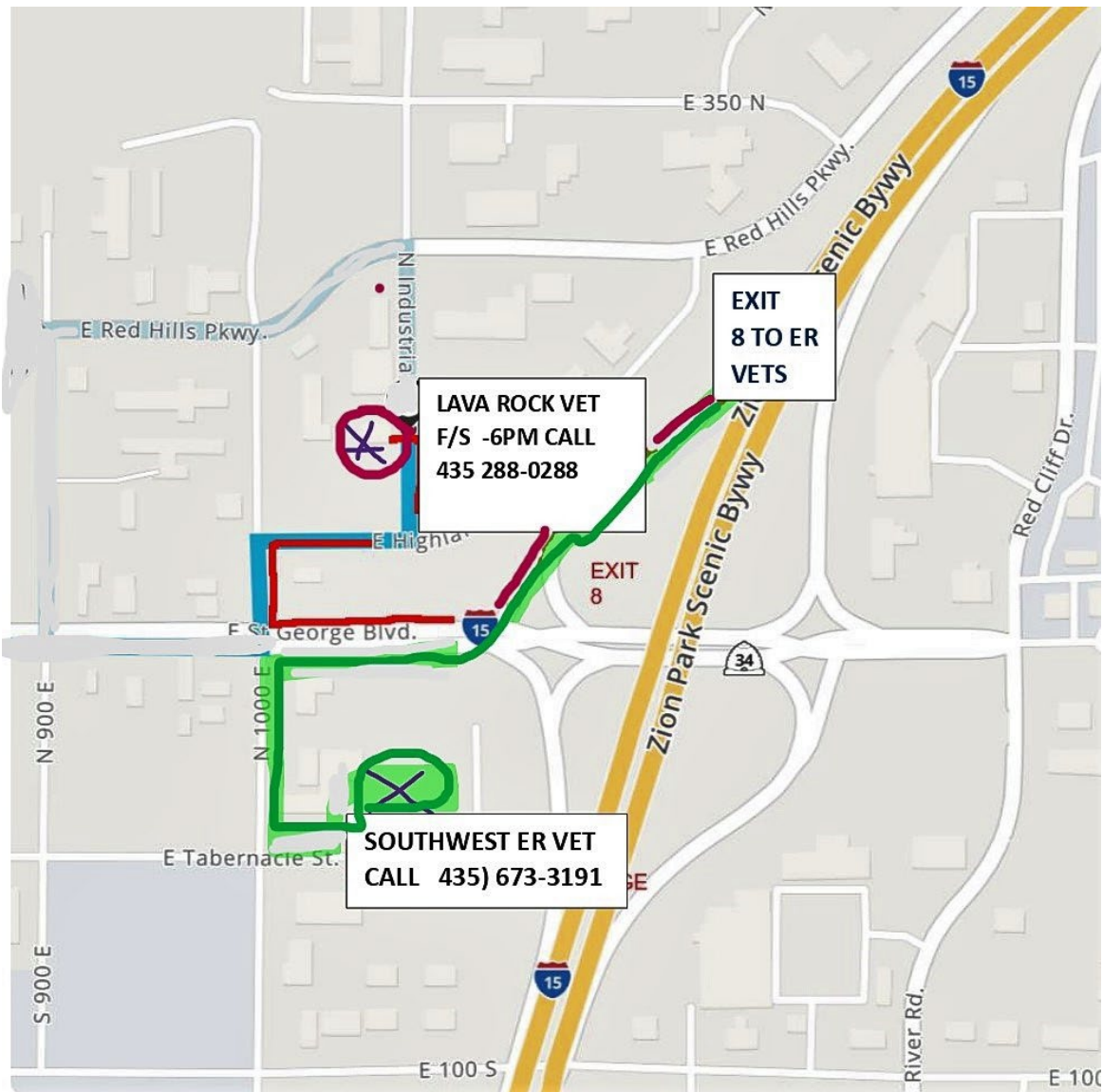

Exhibitors should follow their veterinarians' recommendation to assure their dogs are free of internal and external parasites, any communicable diseases, and have appropriate vaccinations.

## Welcome All Dog Fanciers to Southern Utah

Planning to come to the Red Canyons Kennel Club, AKC Class A Show, September 8<sup>th</sup>, 9<sup>th</sup>, and 10<sup>th</sup> 2023?

In addition to our all-breed conformation and Rally/ Obedience Shows, there is so much to see and do here in Southern Utah.

The area is rated one of the most scenic parts of the USA. For the outdoor enthusiasts, there are plenty of hiking, biking, off-roading, and photography opportunities. In less than a couple of hours you can get to the Big Five National Parks, north rim of the Grand Canyon and lots of State Parks, Monuments and BLM lands. You can travel from high desert to awe-inspiring rock formations, to alpine forests in a single day.



For the amateur archeologist, geologist, paleologist, there are petroglyphs and dinosaur sites throughout the region. Washington and Iron counties host numerous city parks and trails.

For the more “inside” adventurer, Southern Utah has is host to:



- Tuacahn Center for the Arts ([www.tuacahn.org](http://www.tuacahn.org))
- One of the largest Shakespeare Festival in the Country ([www.bard.org](http://www.bard.org))

- Southern Utah Museum of Art

- Kanab Museum
- St George Opera House



- Sand Hollow Aquatic Center
- St George Dinosaur Discovery Site ([www.utahdinosaurs.org](http://www.utahdinosaurs.org))
- 18 golf courses in Washington County and 3 in Iron County ([www.golflink.com/golf-courses/ut/washington/](http://www.golflink.com/golf-courses/ut/washington/))
- And many, many more places to see and enjoy

See for yourself why Southern Utah is one of the fastest growing parts of the Country.

Need to plan your stay? Check out our Preferred Hotel/Motels/RV Park list in the Premium. 30amp and 50amp RV parking will be offered at the County Fairgrounds, through the Club. For reservations, go to our website ([www.redcanyonskc.org](http://www.redcanyonskc.org)).





**Red Canyons Kennel Club Class A Show**

**\$135**

**Call (435) 634-7768 to make your reservation**



**Complimentary Breakfast  
Special Gift Bag  
Pet Photo Opp Spots  
4 Pet Maximum**

by HILTON™

1251 S Sunland Dr.  
St. George, UT 84790



### Address

205 North 1000 East, St. George, UT, 84770

### Phone

(435) 628-7979

Website (For Info & reservations)

<https://www.motel6.com/en/home/property/st-george.html>

[ty/st-george.html](https://www.motel6.com/en/home/property/st-george.html)

We'll leave the light on for you

# Motel 6 Saint George, Ut

#4673 | ★★★★★ 1710 reviews

Motel 6 Saint George, UT is a proud supporter of the Red Canyons Kennel Club AKC Class A Show this year. In addition to the amenities listed below, Hotel Management is willing to relax the number of dogs allowed per room. They understand the unique needs for dog show exhibitors.

## Hotel amenities

Pets allowed

Disabled access

Business center

Nonsmoking rooms

Balcony

Free parking

Swimming pool

Restaurant on site

Snacks soda coffee candy Deli

Television in room

Free WiFi

Family friendly

Air conditioning



## Red Canyons Kennel Club Preferred Hotels, Motels, and RV Parks

First - Thank you to all prior years' Exhibitors! A common comment made by Hotel/Motel/RV Park Management is what a pleasure it is hosting our Red Canyons Kennel Club Show participants and how much they enjoy having all the beautiful dogs walking around their property. The following is a list of Preferred Providers which allow dogs. Some have even relaxed parts of their pet policies and/or offer discounted room rates – Let them know that you are coming to the RCKC Dog Show and confirm all the details and policies below when making reservations.

**Tru by Hilton (435)634-7768 / 1251 Sunland Dr, St George UT (13 miles to Fairgrounds)**  
Tru by Hilton St. George UT St. George | [Bookonline.com](http://Bookonline.com) Tru is going all out this year to make your dog show stay a memorable one. **They are offering special room rates and have relaxed their policy to allow up to 4 dogs per room. Check out their full-page ad, included in the Premium, for more details and special benefits for our Exhibitors.**

**Motel 6 St George Utah (435) 628-7979 / 205 North 1000 East, St. George, UT, 84770 (14 miles) / <https://www.motel6.com/en/home/property/st-george.html>**  
Motel 6 is known for their budget friendly rates and Motel 6 St George is no exception. There is no additional charge for 2 dogs and they understand the special needs for dog show people so they are relaxing their policy to allow additional dogs per room. Check out their amenities in the full-page ad included in the Premium. Motel 6 St George wants to welcome all our Exhibitors to town and is also a proud Group Rosette Sponsor

**Holiday Inn Express (435) 986-1313 / 2450 N Town Center Dr, Washington UT 84780 (13 miles) / [www.reservationdesk.com/hotel/611fe1e/holiday-inn-express-st-george-north-zion-washington-ut/](http://www.reservationdesk.com/hotel/611fe1e/holiday-inn-express-st-george-north-zion-washington-ut/)** Holiday Inn Express has been a preferred hotel for a few years now. They are offering a block of rooms at a discounted rate. Pet policy allows up to 2 dogs per room at \$25 per dog/per day. There are several pet relief centers around the property for your convenience.

**My Place Hurricane Hotel (435)635-8888 / 1167 West 80 S , Hurricane UT 84737 (4 miles) [www.myplacehotels.com/my-place-hotel-hurricane-ut](http://www.myplacehotels.com/my-place-hotel-hurricane-ut)** My Place is allowing up to 3 dogs per room for an additional \$10 per room per night. Rooms include a "My Kitchen" feature with refrigerator, 2 burner cooktop and microwave. Check their website for more details.

**Best Western Plus Zion West Hotel (435)635-.0277 or Toll Free (800)780-7234 / 44 W 500 N, LaVerkin UT / Pet Policy = Up to 2 pets for \$20 per day with \$100 week max. Large grassy area available for leashed pets**

**La Quinta (435)635-3111 (Current pet policy not confirmed)** 101 E 500 N, LaVerkin UT 84745

### RV Parking

**Willow Wind RV (435)635-4154 80 S 1150 W Hurricane UT 84737 (6.5 Miles)**  
Small off-leash dog run available plus several pick up spaces and dog walking areas

**KOA STG/Hurricane (435)850-6382 (Not Confirmed) 5800 N Old Hwy 91, Hurricane UT 84737**

**Zion West RV Park (Smaller rigs) 175 S Valley Rd Hurricane 84746**  
Southern Utah RV Park 435 669.2242 720 E merit Way, Washington UT 84780  
Minimum 1 week reservation (7th day free) . Call for current amount of pet fee. Park provides grassy fenced in areas where dogs may be let off leash.

There are numerous other first-rate hotels in the area as Southern Utah is a major tourist destination area due to the multitude of recreational activities.

# 2023 RCKC SHOW MAP

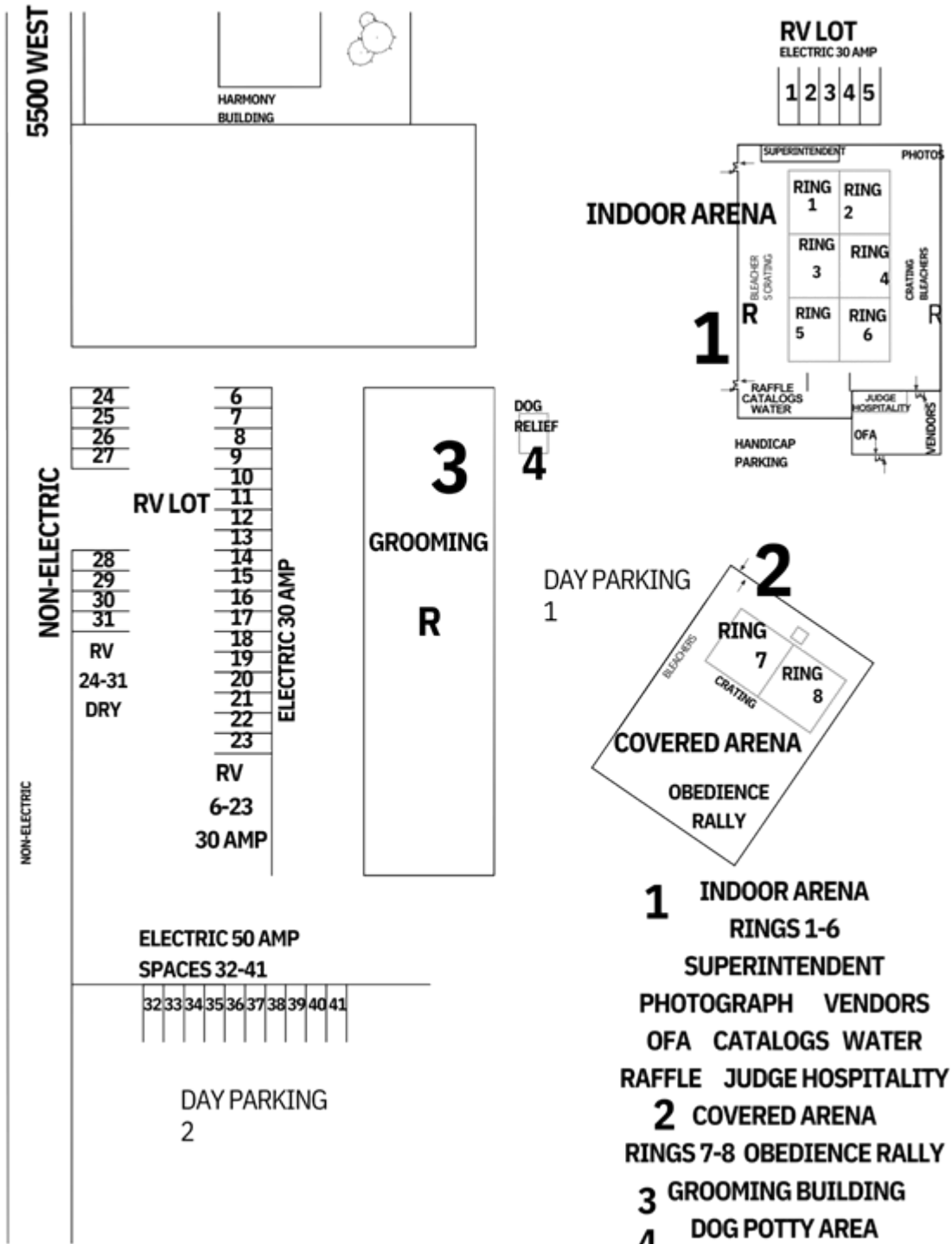

## RV & OVERNIGHT PARKING

**reservations online will open on or by June 7 2023**

All reservations for overnight parking will be taken online at our club website link:

<https://www.redcanyonskc.org/red-canyons-kennel-club-all-breed-show>

club home page link <https://www.redcanyonskc.org/>

Please read the following and refer to the diagram before making your reservations as our parking layout has changed. Due to a venue glitch caused by a change in management at Legacy Park, we will have a different logistical site setup FOR THIS YEAR ONLY

**Reservations close on NOON, Wed, August 23, 2023 MT, at which time no refunds will be issued.** You are welcome to sell or give away your space after close of reservations but must let us know who will be using that space

**We now have some 50amp spots. All reservations are first come first served.**

**Prices include from 3:00 pm Thursday - Sunday 9:00 pm .**

No partial days accepted.

If you wish to stay Sunday evening, you must approve it through the Show Chair no later than Sunday at 10:00 am. All vehicles will be required to vacate the premises by 10:00 am Monday morning.

Conformation Rings: 1-6 in INDOOR ARENA

Obedience / Rally Rings: 7-8 COVERED ARENA

POWER RV – 10 - 50 amp,

16 - 30 amp, 5 – HDCP 30 amp,

46 – non-electric

20 x 48 spaces maximum.

Anything longer than 48 must unhook and park in the back of the day parking at \$5.00/day or purchase two power RV spaces.

**Prices:**

**\$220 – 50 amp RV SPACES 32-41**

**\$180 – 30 amp RV SPACES 6-23**

**HANDICAP RV SPACES 1-5 30 AMP (must have valid HDCP certification to reserve)**

**\$125 – non=electric, SPACES 24-31**



## Red Canyon Kennel Club OFA Health Clinics

. We Please to announce we have two wonderful Veterinarians to do our Health Clinic, Please take advantage of the services offered by the specialists that we arranged to do our OFA and Health Clinic at discounted rate.

- **Date Sat & Sun Sept 9 & 10 2023**
- **Time 9-5 pm both Saturday and Sunday**

**Appointments must be scheduled at the show, or you are welcome to be a walk-in customer**

**Amy Knollinger, DVM, DACVO for Eye Cert Exams will be \$45.00**

**Julia Alpert, DVM** Will be offering the following

OFA Thyroid \$150

Cardiac by Auscultation \$25

OFA Patella \$25

OFA Dentition \$25

Rabies Vaccination \$25

Microchip (AKC ISO compatible) \$35

Brucellosis Testing \$55

Ultrasound for Pregnancy \$75



## **RCKC RESERVED GROOMING**

Indoor grooming spaces are available for reservation online in the horse stall building. It is a cooled building with all spaces being approximately 10 x 10 feet. Cost is **\$80** per space for the entire weekend. See grooming building hours and online reservation link below.

Each space will be approximately 10ft x 10ft and any variance in individual spaces must be accepted. **Power is shared** from overhead outlets and poles which is not exclusive to individual spaces. Please bring extension cords for access to the power. A club ladder(s) will be available in the building should you need to access high overhead power. Some stalls will have club extension cords attached to the higher outlets available for use. Please do not remove these extension cords. If you have a stall with an outlet pole you **MUST** share it. Forced air dryers and stand dryers are permitted for use inside your stall only. Generators will not be permitted in the grooming building. Bathing tub stations are provided courtesy of RCKC.

**A list of pre-reserved stalls assignments will be posted at the main door to the grooming building.**

**Reserved grooming building hours will be as follows:**

**Thursday 3:00 PM - 10:00 PM**

**Friday & Saturday 6:00 AM - 10:00 PM**

**Sunday 6:00 AM - 8:00 PM**

**Dogs are permitted to be left overnight in the grooming building at their own risk and with the following guidelines.**

**RCKC will not be held liable and/or responsible for dogs left unattended in the grooming building. RCKC may choose to have building security overnight, but this is not to be expected or guaranteed.**

No dogs should be left unattended on grooming tables at any time. It is the sole responsibility of the exhibitor to attend to their dog's safety. Failure to follow the rules and regulations or the instructions of any show committee member may result in the forfeiture of your grooming space.

**Exhibitors are responsible to keep their reserved space clean. Do NOT leave trash in your stall.** Please respect the adjoining spaces of the others around you. RCKC will not be responsible for lost, damaged, or stolen items in the grooming building. You are welcome to padlock your space during the show.

Vehicles will have 30 minutes to unload in the area marked for unloading, then you must move your vehicle to designated parking areas. Vehicles left in the unloading area more than 30 minutes will be ticketed and fined \$50. The vehicle may also be towed at the owner's expense.

RESERVATIONS WILL BE TAKEN ONLINE THROUGH RED CANYON KENNEL CLUB'S SHOW PAGE WHERE YOU WILL NEED TO CLICK THE RESERVED GROOMING BUTTON : <https://www.redcanyonskc.org/red-canyons-kennel-club-all-breed-show>

Grooming spaces are limited. We recommend that you reserve your space online to guarantee that you will have one. If you desire to be with another exhibitor, you must purchase your reservations together. No more than 4 spaces per reservation and no guarantee of more than 2 adjoining spaces. If there are any remaining grooming spaces available, they may be reserved on the day of the show on a first come, first served basis. Please read all reservation information before submitting your reservation. By submitting your reservation, you agree to accept your

## PRIZE LIST

### AM SHOW 1 FRIDAY SEPT 9 2022 HURRICANE UTAH

#### BEST IN SHOW \$100

Dave Showalter Sharcon Great Danes

#### OWNER HANDLER BEST IN SHOW

\$75 Wynn Mulliner Construction Inc, Washington, UT

#### RESERVE BEST IN SHOW \$50

Nathan and Erica Muno. Munaut Poodles and Italian Greyhounds

#### RESERVE BEST IN SHOW OWNER HANDLER \$50

#### SPORTING GROUP

Lorene Chidester of CHIC English Springer Spaniels

#### HOUND GROUP \$40

#### WORKING GROUP \$40

#### TERRIERS GROUP \$40

#### TOY GROUP \$40

#### NON SPORTING GROUP \$40

#### HERDING GROUP \$40

Bob and Pam Earl of Earl's Corgis

#### OWNER HANDLER SPORTING GROUP \$40

Lorene Chidester of CHIC English Springer Spaniels

#### OWNER HANDLER HOUND GROUP \$40

Kristi Martin Ruffwyr Dachshunds in memory of KATIE UKC CH Ruffwyr's Chattanooga Choo Choo

#### OWNER HANDLER WORKING GROUP \$40

Marlece Loper, Dragon House Of Danes

#### OWNER HANDLER TERRIER GROUP \$40

#### OWNER HANDLER TOY GROUP \$40

Connie Simms Kahuna Chihuahuas

#### OWNER HANDLER HERDING GROUP \$40

#### OWNER HANDLER NON SPORTING GROUP \$40

Karen Green Desert Reef Standard Poodles

#### Best in Misc Class \$40

Kathryn Martel Sunnystone Peruvian Hairless Dogs

#### Best Junior Handler in Show

Colinda Anderson \$40 chewy gift card

### PM SHOW 2 FRIDAY SEPT 8 2023

#### BEST IN SHOW \$100

Dave Showalter Sharon Great Danes

#### OWNER HANDLER BEST IN SHOW \$75

Wynn Mulliner Construction Inc, Washington, UT

#### RESERVE BEST IN SHOW \$50

Nathan and Erica Muno. Munaut Poodles and Italian Greyhounds

#### RESERVE BEST IN SHOW OWNER HANDLER \$50

#### SPORTING GROUP \$40

Lorene Chidester of CHIC English Springer Spaniels

#### HOUND GROUP \$40

#### WORKING GROUP \$40

#### TERRIERS GROUP \$40

#### TOY GROUP \$40

#### NON SPORTING GROUP \$40

#### HERDING GROUP \$40

Bob and Pam Earl of Earl's Corgis

**OWNER HANDLER SPORTING GROUP \$40**

Lorene Chidester of CHIC English Springer Spaniels

**OWNER HANDLER HOUND GROUP \$40**

Kristi Martin Ruffwyr Dachshunds

**OWNER HANDLER WORKING GROUP \$40**

**OWNER HANDLER TERRIER GROUP \$40**

**OWNER HANDLER TOY GROUP \$40**

**OWNER HANDLER HERDING GROUP \$40**

**OWNER HANDLER NON SPORTING GROUP \$40**

**BEST JR HANDLER IN SHOW \$40 chewy gift card**

**BEST IN MISC CLASS \$40**

Kathryn Martel Sunnystone Peruvian Hairless Dogs

**OBEDIENCE HIGH SCORE IN SHOW \$40**

**OBEDIENCE HIGH COMBINE SCORE IN OPEN B AND UTILITY \$45**

Bob and Pam Earl of Earl's Corgis

**RALLY HIGH COMBINE ADVANCE B & EXCELLENT B \$45**

Nancy Bentley

**RALLY TRIPLE SCORE IN ADVANCE B, EXCELLENT B AND MASTER CLASSES \$5**

**SATURDAY SEPT 9 2023**

**BEST IN SHOW \$100**

Dave Showalter Sharcon Great Danes

**OWNER HANDLER BEST IN SHOW \$75**

Wilding Wallbeds 1509 S 270 E Suite #3, St. George, UT 84790 (866) 525-6897

**RESERVE BEST IN SHOW \$50**

Nathan and Erica Muno. Munaut Poodles and Italian Greyhounds

**RESERVE BEST IN SHOW OWNER HANDLER \$50**

Farah Baldwin LeFevre & Kurt Built of Geffen Mastiffs

**SPORTING GROUP**

Lorene Chidester of CHIC English Springer Spaniels

**HOUND GROUP \$40**

**WORKING GROUP \$40**

Misty Hamilton Mistymoor Dogo Argentino

**TERRIERS GROUP \$40**

Rebecca White of WhiteOaks Cairn Terriers

**TOY GROUP \$40**

**NON-SPORTING GROUP \$40**

**HERDING GROUP \$40**

Bob and Pam Earl of Earl's Corgis

**OWNER HANDLER SPORTING GROUP \$40**

Lorene Chidester of CHIC English Springer Spaniels

**OWNER HANDLER HOUND GROUP \$40**

Kristi Martin Ruffwyr Dachshunds

**OWNER HANDLER WORKING GROUP \$40**

**OWNER HANDLER TERRIER GROUP \$40**

Rebecca White of WhiteOaks Cairn Terriers

**OWNER HANDLER TOY GROUP \$40**

**OWNER HANDLER HERDING GROUP \$40**

**OWNER HANDLER NON-SPORTING GROUP \$40**

**Best in Misc Class \$40**

Kathryn Martel Sunnystone Peruvian Hairless Dogs

**BEST JR HANDLER IN SHOW \$40 chewy gift card**

**OBEDIENCE HIGH SCORE IN SHOW \$40**

Lori Holohan Iron Vista Ranch

**OBEDIENCE HIGH COMBINE SCORE IN OPEN B AND UTILITY \$45**

**RALLY HIGH COMBINE SCORE IN ADVANCE B & EXCELLENT B \$45**

MaKayla Humphries Buckelwurmer German Shepherds

**RALLY TRIPLE SCOREN IN ADVANCE B, EXCELLENT B AND MASTER CLASSES \$50**

**SUNDAY SEPT 9 2023**

**PRIZE** custom money rosettes minimum value listed Unless noted otherwise

**BEST IN SHOW \$100**

Dave Showalter Sharcon Great Danes

**OWNER HANDLER BEST IN SHOW \$75**

Wynn Mulliner Construction Inc, Washington, UT

**RESERVE BEST IN SHOW \$50**

Nathan and Erica Muno. Munaut Poodles and Italian Greyhounds

**RESERVE BEST-IN-SHOW OWNER HANDLER \$50**

**SPORTING GROUP**

Lorene Chidester of CHIC English Springer Spaniels

**HOUND GROUP \$40**

**WORKING GROUP \$40**

Motel 6, 205 North 1000 East, St George Utah 84770 (435)628-7979

**TERRIERS GROUP \$40**

**TOY GROUP \$40**

**NON-SPORTING GROUP \$40**

**HERDING GROUP \$40**

Bob and Pam Earl of Earl's Corgis

**OWNER HANDLER SPORTING GROUP \$40**

Lorene Chidester of CHIC English Springer Spaniels

**OWNER HANDLER HOUND GROUP \$40**

Kristi Martin Ruffwyr Dachshunds

**OWNER HANDLER WORKING GROUP \$40**

**OWNER HANDLER TERRIER GROUP \$40**

**OWNER HANDLER TOY GROUP \$40**

**OWNER HANDLER HERDING GROUP \$40**

**OWNER HANDLER NON-SPORTING GROUP \$ 40**

**Best in Misc Class \$40**

Kathryn Martel Sunnystone Peruvian Hairless Dogs

**BEST JR HANDLER IN SHOW RCKC \$40 chewy gift card**

**OBEDIENCE HIGH SCORE IN SHOW \$40**

Lori Holohan Iron Vista Ranch

**OBEDIENCE HIGH COMBINE SCORE IN OPEN B AND UTILITY \$45**

**RALLY HIGH COMBINE SCORE IN ADVANCE B & EXCELLENT B \$45**

Nancy Bentley

**RALLY TRIPLE SCOREN IN ADVANCE B, EXCELLENT B AND MASTER CLASSES \$50**

**Donations made General Trophy Fund for supplies to make the money rosettes**

Risa Baumrind

Lorene Chidester

Lori Holohan Iron Vista Ranch

Polly Pierce

**OFFICIAL AMERICAN KENNEL CLUB ENTRY FORM**

- RED CANYONS KENNEL CLUB, Friday, Sept 8, 2023 AM SHOW 1**
- RED CANYONS KENNEL CLUB, Friday, Sept 8, 2023 PM SHOW 2**
- RED CANYONS KENNEL CLUB, Saturday, Sept 9, 2023**
- RED CANYONS KENNEL CLUB, Sunday, Sept 10, 2023**

WASHINGTON COUNTY REGIONAL LEGACY PARK FAIRGROUNDS  
5500 West 700 South ( Indoor & Covered Arena ), Hurricane, UT 84737

MAIL ENTRIES WITH FEES TO: JACK BRADSHAW, Supt., 320 Maple Avenue, Torrance, CA 90503

MAKE CHECKS payable to JACK BRADSHAW. FAX (323) 727-2949 website: www.jbradshaw.com

ENTRIES must be received by the Superintendent not later than **NOON, Wed, August 23, 2023 PT**

FIRST ENTRY of a dog at each show **\$32.00**, Each additional entry of the same dog **\$28.00**

Puppy **\$28.00**, Junior Showmanship **\$20.00**, Junior Showmanship as an additional class **FREE**

ENTRY MUST BE SIGNED at the bottom by the owner or owner's duly authorized agent, otherwise entry cannot be accepted. I enclose \$\_\_\_\_\_ for entry fees.

BREED	VARIETY 1	SEX	
DOG 2 3 SHOW CLASS	CLASS 3 DIVISION Weight, color, etc.		
ADDITIONAL CLASSES	OBEDIENCE CLASS (Jump Height)	RALLY CLASS (Jump Height)	JR. SHOWMANSHIP CLASS
NAME OF (See Back) JUNIOR HANDLER (if any)			JR. HANDLER NUMBER

FULL  
NAME  
OF DOG

<input type="checkbox"/> AKC® NO. <input type="checkbox"/> PAL NO. <input type="checkbox"/> FOREIGN REG NO & COUNTRY	Enter number here DATE OF BIRTH <hr/> PLACE OF BIRTH (list country) <small>Do not print the above in the catalog.</small>
--	--

BREEDER

SIRE

DAM

ACTUAL OWNER(S) <small>4</small> _____ <small>(Please Print)</small>
OWNER'S ADDRESS _____
CITY _____ STATE _____ ZIP _____

NAME OF OWNER'S AGENT  
(IF ANY) AT THE SHOW \_\_\_\_\_

I CERTIFY that I am the actual owner of the dog, or that I am the duly authorized agent of the actual owner whose name I have entered above. In consideration of the acceptance of this entry, I (we) agree to abide by the rules and regulations of the American Kennel Club in effect at the time of this event, and by any additional rules and regulations appearing in the premium list for this event, and further agree to be bound by the "Agreement" printed on the reverse side of this entry form. I (we) certify and represent that the dog entered is not a hazard to persons or other dogs. This entry is submitted for acceptance on the foregoing representation and Agreement. I (we) agree to conduct myself (ourselves) in accordance with all such Rules and Regulations (including all provisions applying to discipline) and to abide by any decisions made in accord with them.

**Signature** of owner or his agent duly authorized to make this entry: \_\_\_\_\_

Daytime  
Telephone \_\_\_\_\_ Email \_\_\_\_\_

Emergency Contact \_\_\_\_\_ Phone \_\_\_\_\_

Owner/Handler Eligible? Yes  No

AKC Rules, Regulations, Policies and Guidelines are available on the American Kennel Club Web site,  
www.akc.org  
AGREEMENT

I (we) agree that the club holding this event has the right to refuse this entry for cause which the club shall deem sufficient. In consideration of the acceptance of this entry and of the holding of this event and of the opportunity to have the dog judged and to win prizes, ribbons, or trophies, I (we) agree to hold the AKC, the event-giving club, their members, directors, governors, officers, agents, superintendents or event secretary and the owner and/or lessor of the premises and any provider of services that are necessary to hold this event and any employees or volunteers of the aforementioned parties, and any AKC approved judge, judging at this event, harmless from any claim for loss or injury which may be alleged to have been caused directly or indirectly to any person or thing by the act of this dog while in or about the event premises or grounds or near any entrance thereto, and I (we) personally assume all responsibility and liability for any such claim; and I (we) further agree to hold the aforementioned parties harmless from any claim for loss, injury or damage to this dog.

Additionally, I (we) hereby assume the sole responsibility for and agree to indemnify, defend and save the aforementioned parties harmless from any and all loss and expense (including legal fees) by reason of the liability imposed by law upon any of the aforementioned parties for damage because of bodily injuries, including death at any time resulting therefrom, sustained by any person or persons, including myself (ourselves), or on account of damage to property, arising out of or in consequence of my (our) participation in this event, however such, injuries, death or property damage may be caused, and whether or not the same may have been caused or may be alleged to have been caused by the negligence of the aforementioned parties or any of their employees, agents, or any other persons.

**I (WE) AGREE THAT ANY CAUSE OF ACTION, CONTROVERSY OR CLAIM ARISING OUT OF OR RELATED TO THE ENTRY, EXHIBITION OR ATTENDANCE AT THE EVENT BETWEEN THE AKC AND THE EVENT-GIVING CLUB (UNLESS OTHERWISE STATED IN ITS PREMIUM LIST) AND MYSELF (OURSELVES) OR AS TO THE CONSTRUCTION, INTERPRETATION AND EFFECT OF THIS AGREEMENT SHALL BE SETTLED BY ARBITRATION PURSUANT TO THE APPLICABLE RULES OF THE AMERICAN ARBITRATION ASSOCIATION. HOWEVER, PRIOR TO ARBITRATION ALL APPLICABLE AKC BYLAWS, RULES, REGULATIONS AND PROCEDURES MUST FIRST BE FOLLOWED AS SET FORTH IN THE AKC CHARTER AND BYLAWS, RULES, REGULATIONS, PUBLISHED POLICIES AND GUIDELINES. 1/1/19**



Please visit

<https://www.instagram.com/jackbradshawdogshows/>

for new information, updates, weather conditions, exhibitor information, etc."



Please like our page at

<https://www.facebook.com/JackBradshawDogShows>

for new information, updates, weather conditions, exhibitor information, etc."

**OFFICIAL AMERICAN KENNEL CLUB ENTRY FORM**

- RED CANYONS KENNEL CLUB, Friday, Sept 8, 2023 AM SHOW 1**
- RED CANYONS KENNEL CLUB, Friday, Sept 8, 2023 PM SHOW 2**
- RED CANYONS KENNEL CLUB, Saturday, Sept 9, 2023**
- RED CANYONS KENNEL CLUB, Sunday, Sept 10, 2023**

WASHINGTON COUNTY REGIONAL LEGACY PARK FAIRGROUNDS  
5500 West 700 South (Indoor & Covered Arena), Hurricane, UT 84737

MAIL ENTRIES WITH FEES TO: JACK BRADSHAW, Supt., 320 Maple Avenue, Torrance, CA 90503

MAKE CHECKS payable to JACK BRADSHAW. FAX (323) 727-2949 website: www.jbradshaw.com

ENTRIES must be received by the Superintendent not later than **NOON, Wed, August 23, 2023 PT**

FIRST ENTRY of a dog at each show **\$32.00**, Each additional entry of the same dog **\$28.00**

Puppy **\$28.00**, Junior Showmanship **\$20.00**, Junior Showmanship as an additional class **FREE**

ENTRY MUST BE SIGNED at the bottom by the owner or owner's duly authorized agent, otherwise entry cannot be accepted. I enclose \$\_\_\_\_\_ for entry fees.

BREED		VARIETY 1		SEX
DOG 2 3 SHOW CLASS		CLASS 3 DIVISION Weight, color, etc.		
ADDITIONAL CLASSES	OBEDIENCE CLASS (Jump Height)	RALLY CLASS (Jump Height)	JR. SHOWMANSHIP CLASS	
NAME OF (See Back) JUNIOR HANDLER (if any)			JR. HANDLER NUMBER	
FULL NAME OF DOG				
<input type="checkbox"/> AKC® NO. <input type="checkbox"/> PAL NO. <input type="checkbox"/> FOREIGN REG NO & COUNTRY		Enter number here	DATE OF BIRTH	
			PLACE OF BIRTH (list country) Do not print the above in the catalog.	
BREEDER				
SIRE				
DAM				
ACTUAL OWNER(S) _____ <small>4</small> (Please Print) OWNER'S ADDRESS _____ CITY _____ STATE _____ ZIP _____				

NAME OF OWNER'S AGENT  
(IF ANY) AT THE SHOW \_\_\_\_\_

I CERTIFY that I am the actual owner of the dog, or that I am the duly authorized agent of the actual owner whose name I have entered above. In consideration of the acceptance of this entry, I (we) agree to abide by the rules and regulations of the American Kennel Club in effect at the time of this event, and by any additional rules and regulations appearing in the premium list for this event, and further agree to be bound by the "Agreement" printed on the reverse side of this entry form. I (we) certify and represent that the dog entered is not a hazard to persons or other dogs. This entry is submitted for acceptance on the foregoing representation and Agreement. I (we) agree to conduct myself (ourselves) in accordance with all such Rules and Regulations (including all provisions applying to discipline) and to abide by any decisions made in accord with them.

**Signature** of owner or his agent duly authorized to make this entry: \_\_\_\_\_

Daytime

Telephone \_\_\_\_\_

Email \_\_\_\_\_

Emergency Contact \_\_\_\_\_

Phone \_\_\_\_\_

Owner/Handler Eligible? Yes

No

AKC Rules, Regulations, Policies and Guidelines are available on the American Kennel Club Web site,  
www.akc.org  
AGREEMENT

I (we) agree that the club holding this event has the right to refuse this entry for cause which the club shall deem sufficient. In consideration of the acceptance of this entry and of the holding of this event and of the opportunity to have the dog judged and to win prizes, ribbons, or trophies, I (we) agree to hold the AKC, the event-giving club, their members, directors, governors, officers, agents, superintendents or event secretary and the owner and/or lessor of the premises and any provider of services that are necessary to hold this event and any employees or volunteers of the aforementioned parties, and any AKC approved judge, judging at this event, harmless from any claim for loss or injury which may be alleged to have been caused directly or indirectly to any person or thing by the act of this dog while in or about the event premises or grounds or near any entrance thereto, and I (we) personally assume all responsibility and liability for any such claim; and I (we) further agree to hold the aforementioned parties harmless from any claim for loss, injury or damage to this dog.

Additionally, I (we) hereby assume the sole responsibility for and agree to indemnify, defend and save the aforementioned parties harmless from any and all loss and expense (including legal fees) by reason of the liability imposed by law upon any of the aforementioned parties for damage because of bodily injuries, including death at any time resulting therefrom, sustained by any person or persons, including myself (ourselves), or on account of damage to property, arising out of or in consequence of my (our) participation in this event, however such, injuries, death or property damage may be caused, and whether or not the same may have been caused or may be alleged to have been caused by the negligence of the aforementioned parties or any of their employees, agents, or any other persons.

**I (WE) AGREE THAT ANY CAUSE OF ACTION, CONTROVERSY OR CLAIM ARISING OUT OF OR RELATED TO THE ENTRY, EXHIBITION OR ATTENDANCE AT THE EVENT BETWEEN THE AKC AND THE EVENT-GIVING CLUB (UNLESS OTHERWISE STATED IN ITS PREMIUM LIST) AND MYSELF (OURSELVES) OR AS TO THE CONSTRUCTION, INTERPRETATION AND EFFECT OF THIS AGREEMENT SHALL BE SETTLED BY ARBITRATION PURSUANT TO THE APPLICABLE RULES OF THE AMERICAN ARBITRATION ASSOCIATION. HOWEVER, PRIOR TO ARBITRATION ALL APPLICABLE AKC BYLAWS, RULES, REGULATIONS AND PROCEDURES MUST FIRST BE FOLLOWED AS SET FORTH IN THE AKC CHARTER AND BYLAWS, RULES, REGULATIONS, PUBLISHED POLICIES AND GUIDELINES. 1/1/19**



Please visit

<https://www.instagram.com/jackbradshawdogshows/>

for new information, updates, weather conditions, exhibitor information, etc."



Please like our page at

<https://www.facebook.com/JackBradshawDogShows>

for new information, updates, weather conditions, exhibitor information, etc."



## ADDITIONAL RULES

1. Entries must reach the Superintendent, Jack Bradshaw by Noon, Wednesday August 23, 2023. Fees should accompany entries. This club and/or its superintendent assumes no responsibility for wrong or incomplete information given on the entry blank by the owner or agent of the owner. This club and its superintendents assume no responsibility for the owner or owner's agents entering a dog in a class in which the dog is not eligible to compete, or for entering the same dog twice.
2. Returned Checks do not constitute a valid entry fee. The Superintendent will add a collection fee to the amount of each returned check and declined credit card. Subsequent returned checks for the same exhibitors may result in their being put on a CASH ONLY basis. The returned check or declined credit card MUST BE MADE GOOD by cash or money order BEFORE the dog will be allowed in the ring.
3. Exhibitors' Identification tickets and judging programs will be mailed to the address given on the entry blank. If not received within a reasonable time prior to the show, notify the superintendent. Tickets returned by the Post Office marked 'undeliverable' will be held at the Superintendent's Office. PLEASE BRING YOUR IDENTIFICATION TICKETS TO THE SHOW.
4. During the hours of judging owners are to be on call, and have their dogs ready to bring into the judging ring promptly. In order that the judging will not be delayed. Dogs need only be present for their judging. Dogs not needed for further judging may be excused. It is the responsibility of the exhibitor to have his dog ready to be shown and at the entrance of the judging ring when the steward calls for the class. Owners of dogs or the handlers of the dogs alone are responsible for the presence of their dogs in the judging rings. This means it is not the responsibility of the ring steward, nor of any agent of the show-giving club to locate any dog, its owner or handler, when the dog's presence is needed in a judging ring. It should be understood by every exhibitor and handler that waiting for dogs to be brought into the ring is a courtesy extended to the owner or handler of the dog. There is no rule of this club nor of The American Kennel Club that requires a judge to wait for an owner or handler to bring his dog into the ring. Because of the Covid-19 pandemic, all exhibits no longer needed for judging and their owners/handlers are asked to leave the Showgrounds as soon as possible.
5. All Trophies and Prizes must be claimed at the Trophy Table. All trophies must be claimed the day of the show. None will be mailed.
6. Exhibitors are admonished to make themselves familiar with the agreement of the American Kennel Club, referred to on the reverse side of the entry blanks that accompany this premium list. Rule books are available online at akc.org
7. The club, its superintendents or their employees will not be responsible for the loss of or damage to any dog exhibited, whether the result of accident or other causes and in addition assumes no responsibility for any loss, damage, injury or death sustained by an exhibitor or handler. It is distinctly understood that every dog at this show is in the care and custody and control of his owner or handler during the entire time the dog is on the show premises.
8. No grooming tables, pens or exhibitors' setups will be allowed in the aisles and all grooming must be done away from the judging ring in areas specified by the club.
9. Entry fees shall NOT be refunded in the event that a dog is absent, disqualified, sick, lame, excused by veterinarian or judge, barred from competition by action of the Bench Show Committee, or because the dog is ineligible to compete due to being entered incorrectly. There is no refund of entry fee for duplicate entry. There will be a \$4.00 fee charged for cancellation of entry prior to closing of entries.
10. There is no provision offered for unentered dogs at this show.
11. Declination of Entries. The Red Canyons Kennel Club may decline any entries for cause and may refuse to receive or may remove any dog on account of disease, viciousness or other causes, and no one shall have any claim or recourse against the Kennel Club or any official thereof.
12. If, because of riots, civil disturbances or other acts beyond the control of the management, it is impossible to open or complete the show, no refund of entry will be made.
13. Do not leave any dogs in closed vehicles.
14. Dogs which according to their owners' records have completed the requirements for a championship after the closing of entries for the show but whose championships are unconfirmed, may be transferred from one of the regular classes to the Best of Breed or Variety Competition, provided this transfer is made by the Superintendent at least one-half hour prior to the start of the earliest Conformation judging at the Show.
15. Junior Handlers who win a third Novice Class after the closing of entries for a show may transfer their entry from the Novice Class to the Open Class provided that this transfer is made by the Superintendent at least one half-hour prior to the scheduled start of the earliest conformation judging or one half-hour prior to the scheduled start of Junior Showmanship judging at the Show, whichever is earlier.
16. All rights to TELEVISION, VIDEOTAPE, ADVERTISE, PHOTOGRAPH, PROMOTE or otherwise exploit this event are vested in the CLUB, or in persons to whom assignments of such rights have been made in writing by the Club. All persons and animals on the Showgrounds at any time while the show is in progress, do by attending this show or participating therein, grant to the Club the right to photograph, televise, video tape, audiotape or otherwise use their likeness and voice in any manner without further release or consent.
17. The Kennel Club is not responsible for the actions or products of the commercial vendors at this show.
18. Dogs which according to their owners' records have earned an obedience or rally title after the closing of entries for the show may be moved up to the next class, provided this transfer is made in writing and presented to the superintendent at least 30 minutes prior to the start of each trial.
19. No practicing is allowed in the rings at any time.
20. Parents and/or guardians are responsible for the actions of their children.
21. By attending this event, you acknowledge that an inherent risk of exposure to COVID-19 exists in any public place where people are present and agree not to hold the superintendent liable for any illness, injury.
22. By attending this event, you voluntarily assume all risks related to exposure to COVID-19 and agree not to hold Jack Bradshaw Dog Shows, its owners, employees, or volunteers liable for any illness, injury..

